

## GENERAL NOTES

### 1. CONTRACTUAL OBLIGATION:

THE GC SHALL ABIDE BY AND BE RESPONSIBLE FOR ALL REQUIREMENTS STATED IN THE AIA DOCUMENT A201 - GENERAL CONDITIONS (CURRENT ISSUE), UNLESS NOTED OTHERWISE.

### 2. GENERAL CONDITIONS:

THE GC SHALL PROVIDE ALL LABOR, MATERIAL, EQUIPMENT, TOOLS, UTILITIES, INSURANCE, TRANSPORTATION, AND PAY FOR ALL REQUIRED TAXES, PERMITS, AND SERVICES REQUIRED TO COMPLETE THE ENTIRE SCOPE OF WORK, WHETHER TEMPORARY OR PERMANENT. ALL MATERIALS EXCEPT TEMPORARY FORMS ARE TO BE NEW, UNUSED AND OF THE SPECIFIED QUALITY. THE GC SHALL MAINTAIN THE PROJECT SITE IN A CLEAN AND ORDERLY FASHION. TOOLS AND EQUIPMENT SHALL BE SECURED, AND ALL DEBRIS SHALL BE REMOVED DAILY. THE GC SHALL MAINTAIN A VISITORS LOG. ALL VISITORS SHALL BE REQUIRED TO SIGN SUCH LOG. DATES AND TIMES OF ENTERING AND EXITING THE SITE FOR ALL VISITORS SHALL BE NOTED. GC TO SECURE PROJECT SITE FROM UNAUTHORIZED ENTRY AT ALL TIMES. COORDINATE LOCATION OF BARRICADES OR TEMPORARY FENCING WITH THE DOCUMENTS AND OWNER. THE GC SHALL PHOTOGRAPH THE PROJECT SITE AND EXISTING CONDITIONS PRIOR TO THE BEGINNING OF THE WORK. PHOTOGRAPHS SHALL BE TAKEN OF THE PROGRESS OF THE WORK AT INTERVALS NO GREATER THAN 7 CALENDAR DAYS. PHOTOGRAPHS SHALL BE IN COLOR AND IDENTIFIED BY DATE AND TIME OF DAY. MAINTAIN DIGITAL PHOTOGRAPH FILE ON SITE. DELIVER COMPLETED FILE TO THE ARCHITECT UPON RECEIPT OF USE AND OCCUPANCY PERMIT. THE GC SHALL MAINTAIN AN ON SITE STAGING AREA AND SHALL KEEP THE AGENCY APPROVED CONSTRUCTION DOCUMENTS, ALL LICENSING INFORMATION, VISITORS LOG, PHOTOGRAPH FILE, AND AT LEAST ONE SET OF REPRODUCIBLE CONSTRUCTION DOCUMENTS, TO BE MARKED CONCURRENTLY WITH THE CONSTRUCTION, TO RECORD ACTUAL CONDITIONS OF THE CONSTRUCTION AND DEVICE INSTALLATIONS. DELIVER COMPLETED REPRODUCIBLE RECORD SET TO THE ARCHITECT UPON COMPLETION OF THE PROJECT. GC TO REMOVE AND DISPOSE OF ALL WASTE AND DEBRIS FROM PROJECT SITE IN A LEGAL MANNER. UPON COMPLETION OF THE WORK, PROVIDE PROFESSIONAL CLEANING SERVICE TO CLEAN THE PROJECT SITE, INTERIOR AND EXTERIOR, FOR FINAL OCCUPANCY.

### 3. GRAPHICS:

EXISTING CONSTRUCTION (PARTITIONS, DOORS, PLUMBING FIXTURES, CASEWORK, EQUIPMENT, ETC.) IS INDICATED ON THE FLOOR PLANS, WITH LINES IN A LIGHTER SHADE (SCREENED). EXISTING WALLS TO REMAIN ARE POCHED. NEW CONSTRUCTION IS INDICATED BY FULL INTENSITY (SOLID) LINES. ITEMS TO BE DEMOLISHED ARE INDICATED IN LIGHT FINELY DASHED LINES.

### 4. INTERPRETATION:

THE ARCHITECT IS SOLELY RESPONSIBLE FOR THE DESIGN INTERPRETATION OF THE CONSTRUCTION DOCUMENTS.

### 5. DOCUMENT DISCREPANCIES:

WHENEVER THERE ARE DISCREPANCIES IN THE CONTRACT DOCUMENTS, THE CONTRACTOR SHALL BASE HIS BID UPON THE BETTER QUALITY OR GREATER QUANTITY OF THE MATERIAL OR WORK DESCRIBED.

### 6. DRAWING SCALE:

THE CONTRACTOR SHALL NOT SCALE DRAWINGS.

### 7. FIELD CONDITIONS:

THE CONTRACTOR SHALL TAKE FIELD MEASUREMENTS AND VERIFY FIELD CONDITIONS AND SHALL CAREFULLY COMPARE SUCH FIELD MEASUREMENTS, CONDITIONS, AND OTHER INFORMATION KNOWN TO THE CONTRACTOR WITH THE CONTRACT DOCUMENTS BEFORE COMMENCING ACTIVITIES. ERRORS, INCONSISTENCIES, OR OMISSIONS DISCOVERED SHALL BE REPORTED TO THE ARCHITECT AT ONCE. NO ALLOWANCE WILL BE MADE ON BEHALF OF THE CONTRACTOR OR SUBCONTRACTORS FOR FAILURE TO VISIT THE SITE.

### 8. CONSTRUCTION MEANS .PROCEDURES:

THE GENERAL CONTRACTOR SHALL SUPERVISE AND DIRECT THE WORK, USING THE CONTRACTOR'S BEST SKILL AND ATTENTION. THE CONTRACTOR SHALL BE SOLELY RESPONSIBLE FOR AND HAVE CONTROL OVER CONSTRUCTION MEANS, METHODS, TECHNIQUES, SEQUENCES AND PROCEDURES AND FOR COORDINATING ALL PORTIONS OF WORK UNDER THE CONTRACT, UNLESS CONTRACT DOCUMENTS GIVE OTHER SPECIFIC INSTRUCTIONS CONCERNING THESE MATTERS. ANY WORK THAT MUST BE REMOVED OR RELOCATED DUE TO LACK OF COORDINATION OF THE TRADES IS SOLELY THE CONTRACTOR'S RESPONSIBILITY. THE CONTRACTOR SHALL MAINTAIN A SECURE SITE THROUGHOUT THE CONSTRUCTION PROCESS.

### 9. BUILDING SYSTEMS:

THE GC SHALL COORDINATE THE LOCATION AND INSTALLATION OF ALL BUILDING SYSTEMS AND EQUIPMENT. THE GC SHALL COORDINATE ALL BUILDING TRADES TO ASSURE ALL REQUIRED CLEARANCES FOR OPERATION AND MAINTENANCE OF ALL EQUIPMENT AND SYSTEMS AS REQUIRED BY CODE, THESE DOCUMENTS, OR MANUFACTURER'S RECOMMENDATIONS ARE MET OR EXCEEDED. LACK OF SPECIFIC DETAILS SHALL NOT BE AN EXCUSE FOR IMPROPER INSTALLATION OF ANY MATERIAL, DEVICE, OR SYSTEM. WHERE DETAILS ARE NOT PROVIDED, THE GC SHALL REFER TO THE PRINTED MANUFACTURER'S RECOMMENDATIONS FOR INSTALLATION GUIDELINES. ALL INSTALLED SYSTEMS AND DEVICES ARE TO OPERATE QUIETLY AND WITHOUT EXCESSIVE VIBRATION. THIS INCLUDES BUT IS NOT LIMITED TO THE FOLLOWING SYSTEMS; MECHANICAL, ELECTRICAL, LIGHTING, PLUMBING, AND TELEPHONE EQUIPMENT.

### 10. CLEARANCES:

THE CONTRACTOR SHALL COORDINATE WITH ALL BUILDING TRADES INVOLVED IN THE PROJECT FOR PREPARATION OF COMPOSITE SHOP DRAWINGS FOR EACH FLOOR TO INSURE PROPER CLEARANCES FOR FIXTURES, DUCTS, CEILINGS, ETC, WHILE MAINTAINING THE SPECIFIED CEILING HEIGHTS NOTED ON THE DRAWINGS. CLARIFY ANY CONFLICTS WITH ARCHITECT.

### 11. LOCATIONS:

ELECTRICAL PANELS, TELEPHONE EQUIPMENT, FIRE EXTINGUISHERS, FIRE PULLS, LIGHTS/HORNS, SMOKE DETECTORS, THERMOSTATS, ETC, SHALL BE LOCATED IN ACCORDANCE WITH REQUIREMENTS OF GOVERNING AGENCIES. ANY LOCATION NOT SPECIFICALLY SHOWN SHALL BE VERIFIED WITH ARCHITECT PRIOR TO ROUGH-OUT AND INSTALLATION. UNLESS OTHERWISE NOTED, THE ABOVE PANELS AND/OR EQUIPMENT SHALL BE FULLY RECESSED & SHALL MAINTAIN THE INTEGRITY OF WALL FIRE RATING REQUIREMENTS.

### 12. GOVERNING AGENCIES:

THE GC AND ALL OF HIS FORCES SHALL COMPLY WITH ALL REGULATIONS BY ANY GOVERNING AGENCY WITH JURISDICTION OVER THE PROJECT OR PROJECT SITE.

### 13. PERMITS/INSPECTIONS:

UNLESS OTHERWISE PROVIDED IN THE CONTRACT DOCUMENTS, THE CONTRACTOR SHALL SECURE AND PAY FOR THE BUILDING PERMIT AND OTHER PERMITS AND GOVERNMENTAL FEES, LICENSES AND INSPECTIONS NECESSARY FOR PROPER EXECUTION AND COMPLETION OF WORK. THE CONTRACTOR SHALL COMPLY WITH AND GIVE NOTICES REQUIRED BY LAWS, ORDINANCES, RULES, REGULATIONS, AND LAWFUL ORDERS OF PUBLIC AUTHORITIES BEARING ON PERFORMANCE OF THE WORK. UPON COMPLETION OF THE WORK, THE CONTRACTOR SHALL OBTAIN A USE AND OCCUPANCY PERMIT AS REQUIRED FROM THE GOVERNING CODES. SUBMIT ONE COPY OF THE PERMIT TO THE OWNER WITH FINAL APPLICATION OF PAYMENT.

### 14. LIFESAFETY TESTING:

THE GC SHALL PROVIDE THE OWNER AND THE LOCAL FIRE DEPARTMENT WRITTEN NOTICE 96 HOURS IN ADVANCE OF ANY LIFE SAFETY SYSTEM SHUT DOWN OR TESTING. THE GC SHALL TELEPHONE THE FIRE DEPARTMENT IMMEDIATELY PRIOR TO SUCH TESTING OR SHUT DOWN TO INFORM THEM OF THE EXACT TIME OF THE ANTICIPATED ALARM CONDITION. THE GC SHALL NOTIFY THE FIRE DEPARTMENT IMMEDIATELY UPON COMPLETION OF THE TEST OR SHUT DOWN TO RE-ESTABLISH EMERGENCY RESPONSE TO ALARM CONDITIONS.

### 15. DOORS:

UNDERCUTTING OF DOORS SHALL BE DONE IN ACCORDANCE WITH NFPA 80 (CURRENT ISSUE) TABLE 1-1.4.

### 16. BLOCKING:

PROVIDE METAL STUD BLOCKING IN PARTITIONS BEHIND ALL WALL HUNG OR WALL MOUNTED EQUIPMENT, MILLWORK, SHELVING, OR OTHER DEVICES.

### 17. TOXIC MATERIAL:

IN THE EVENT THE CONTRACTOR ENCOUNTERS ON THE SITE MATERIAL REASONABLY BELIEVED TO BE ASBESTOS, POLYCHLORINATED BIPHENYL (PCB) OR OTHER TOXIC MATERIAL, WHICH HAS NOT BEEN RENDERED HARMLESS, THE CONTRACTOR SHALL IMMEDIATELY STOP WORK IN THE AREA AFFECTED, SEAL OFF THE PERIMETER, AND REPORT THE CONDITION TO THE OWNER AND ARCHITECT IN WRITING. NO NEW BUILDING MATERIAL SHALL CONTAIN ASBESTOS, POLYCHLORINATED BIPHENYL (PCB) OR OTHER TOXIC MATERIAL AS DEFINED BY STATE AND FEDERAL REGULATORY AGENCIES.

### 18. PARTITIONS:

PARTITIONS EXTENDING TO THE STRUCTURE ABOVE SHALL BE TIGHTLY SEALED. THE INTEGRITY OF RATED ASSEMBLIES AND SMOKE BARRIERS SHALL BE MAINTAINED AT CORNERS AND INTERSECTIONS OF LOWER PRIORITY PARTITIONS. ALL HORIZONTAL AND VERTICAL FIRE AND/OR SMOKE BARRIERS, INCLUDING ALL FLOOR STRUCTURES, SHALL BE CONTINUOUS FROM OUTSIDE WALL TO OUTSIDE WALL, FROM ONE BARRIER TO ANOTHER, OR COMBINATION THEREOF. BARRIERS MUST BE CONTINUOUS THROUGH CONCEALED SPACES AND INTERSTITIAL SPACES. SEAL COMPLETELY ALL OPENINGS WITH UL (OR OTHER TESTING AGENCY) APPROVED ASSEMBLIES WHERE FIRE BARRIERS ARE PENETRATED OR ABOUT OTHER FIRE BARRIERS, EXTERIOR WALLS, AND FLOORS ABOVE AND BELOW BARRIER. ALL FIRE BARRIERS ARE TO BE CONSTRUCTED ACCORDING TO THE TESTING LABORATORY SPECIFICATIONS. ALL SMOKE BARRIERS SHALL BE A MINIMUM OF 1-HOUR FIRE RESISTANT CONSTRUCTION. CORRIDOR PARTITIONS, SMOKE STOP PARTITIONS, HORIZONTAL EXIT PARTITIONS, EXIT ENCLOSURES, AND ALL FIRE RATED WALLS SHALL BE PERMANENTLY IDENTIFIED WITH STENCILING. SUCH IDENTIFICATION SHALL BE ABOVE ANY DECORATIVE CEILING AND IN CONCEALED SPACES. STENCILING TO BE IN RED LETTERS, NO LESS THAN 4" TALL WITH A RED BAND EXTENDING THE LENGTH OF THE PARTITION. STENCILED IDENTIFICATION TO READ "1X HOUR RATED FIRE AND/OR SMOKE BARRIER, PROTECT ALL OPENINGS". STENCILED IDENTIFICATION TO BE POSITIONED TO BE READILY VISIBLE FROM BOTH SIDES OF THE BARRIER AND SUCH THAT FROM ANY ACCESS POINT AT LEAST ONE IDENTIFICATION MARKER MAY BE READ.

### 19. PENETRATIONS:

PENETRATIONS OF PIPES, TUBES, CONDUIT, WIRES, CABLES, DUCTS, VENTS, CABINETS, LIGHTING, AND OTHER FIXTURES THROUGH FIRE RATED ASSEMBLIES SHALL BE INSTALLED AND PROTECTED TO MAINTAIN FIRE RATING.

### 20. PROTECTION OF FLOOR SURFACES:

CONTRACTOR SHALL PROVIDE ADEQUATE PROTECTION FOR ALL FINISHED FLOOR SURFACES, EXISTING OR NEW INCLUDING BUT NOT LIMITED TO, CERAMIC TILE, VINYL TILE, CONCRETE, ETC., THROUGHOUT THE CONSTRUCTION PERIOD.

### 21. COMMUNICATION EQUIPMENT:

THE GC SHALL COORDINATE THE WORK HE IS RESPONSIBLE FOR WITH THE OWNER'S COMMUNICATION SERVICE PROVIDERS. COORDINATE THE LOCATION OF ALL SYSTEM CONTROLS WITH THE ELECTRICAL SYSTEM INSTALLER, THE OWNER, AND THE ARCHITECT PRIOR TO INSTALLATION. OWNER'S COMMUNICATION PROVIDER TO ASSURE THAT JUXTAPOSING OF ELECTRICAL AND DATA LINES WILL NOT RESULT IN INTERFERENCE, STATIC, OR IN ANY OTHER WAY DISRUPT THE NORMAL FUNCTION OF THE DATA/COMMUNICATION SYSTEMS).

### 22. SUBSTRATE PREPARATIONS:

ALL SUBSURFACES SHALL BE PROPERLY PREPARED BEFORE APPLICATION OF FINISHES. CONTRACTOR SHALL ASSUME RESPONSIBILITY FOR SUBSTRATE CONDITIONS WHERE FINISHES ARE APPLIED.

### 23. DIMENSION STANDARDS:

DIMENSIONS ARE NOT ADJUSTABLE UNLESS NOTED WITH A +/- SYMBOL. ONLY NORMAL INDUSTRY STANDARD TOLERANCES ARE ACCEPTABLE DEVIATIONS FROM DIMENSIONS INDICATED. DO NOT SCALE DRAWINGS. ALL DIMENSIONS NOTED AS "CLEAR" SHALL MAINTAIN THE FULL SPACE INDICATED WITHOUT ENCROACHMENTS. ALL VERTICAL HEIGHTS INDICATED ARE FROM THE FINISH FLOOR ELEVATION AT THE BASE OF THE ITEM INDICATED, UNLESS NOTED OTHERWISE. WHERE WALLS, JAMBS, OR OTHER ITEMS ARE NOTED TO "ALIGN", THE FACE OF ITEMS INDICATED SHALL BE IN LINE WITH EACH OTHER TO FORM A STRAIGHT LINE, FREE OF OFFSETS OR DEVIATIONS. FIELD VERIFY ALL DIMENSIONS. UNLESS NOTED OTHERWISE, DIMENSIONS ARE ACTUAL, NOT NOMINAL, AS FOLLOWS:

COLUMNS - FROM CENTER LINE TO CENTERLINE  
INTERIOR PARTITIONS- FROM STUD FACE TO STUD FACE  
CONCRETE// MASONRY - FROM FINISH FACE TO FINISH FACE  
EXTERIOR WALLS - FROM EXTERIOR FACE TO INTERIOR FINISH FACE OF WALL

## RENOVATION GENERAL NOTES

### 1. PROTECTION OF EXISTING TO REMAIN:

THE CONTRACTOR SHALL PROVIDE PROTECTIVE COVERING FOR CARPET, FURNISHINGS, AND FINISHES IN EXISTING AREAS NOT DESIGNATED FOR DEMOLITION OR NEW CONSTRUCTION. THE CONTRACTOR SHALL BE RESPONSIBLE FOR THE REPAIR OF ANY DAMAGE CAUSED BY HIS WORK OR ANY SUBCONTRACTOR. IN PARTICULAR, THE CONTRACTOR SHALL MAINTAIN A DUST-FREE ENVIRONMENT WITHIN THE MAGNET VAULT.

### 2. SCHEDULING

THE CONTRACTOR SHALL MEET WITH THE OWNER'S AUTHORIZED REPRESENTATIVE WELL IN ADVANCE OF CONSTRUCTION COMMENCEMENT TO:

A. SCHEDULE, SEQUENCE AND COORDINATE ALL WORK

B. MAINTAIN EXITS AND EGRESS WIDTHS REQUIRED BY CODES DURING ALL PHASES OF CONSTRUCTION

### 3. CLEARANCES

THE CONTRACTOR SHALL VERIFY THAT NEW CEILINGS CAN BE INSTALLED IN EXISTING SPACES TO CLEAR DUCTWORK AND OTHER CONSTRUCTED ITEMS AND MAINTAIN FLOOR TO CEILING HEIGHTS INDICATED ON DRAWINGS. IF DISCREPANCIES OCCUR DUE TO EXISTING CONDITIONS, CONSULT WITH THE ARCHITECT BEFORE PROCEEDING.

### 4. MATERIAL ALIGNMENT

THE FINISH FACE OF MATERIAL OF NEW PARTITIONS SHALL ALIGN ON BOTH SIDES OF THE PARTITION WITH THE FACE OF THE MATERIALS ON EXISTING COLUMNS, WALLS, OR PARTITIONS, UNLESS NOTED OTHERWISE.

### 5. AS BUILT VERIFICATION

THE CONTRACTOR SHALL VERIFY DIMENSIONS OF AS-BUILT CONDITIONS, AND NOTIFY THE ARCHITECT IN WRITING OF ANY DISCREPANCIES. ALL INFORMATION SHOWN ON THE CONSTRUCTION DOCUMENTS IS BASED ON FIELD OBSERVATIONS AND/OR THE ORIGINAL CONSTRUCTION DOCUMENTS OF THE FACILITY.

### 6. REMOVAL SURVEY

THE CONTRACTOR SHALL SURVEY AND DETERMINE THE REMOVAL OF EXISTING CONSTRUCTION, EITHER WHOLE OR IN PART, AS REQUIRED FOR THE INSTALLATION OF THE NEW MECHANICAL, PLUMBING AND ELECTRICAL WORK.

### 7. CONSTRUCTION DEFECTS:

THE CONTRACTOR SHALL NOTIFY THE ARCHITECT IN WRITING OF ANY CONSTRUCTION DEFECTS FOUND IN UNCOVERING WORK IN THE EXISTING CONSTRUCTION.

### 8. CORRECTING DEFECTIVE WORK

THE CONTRACTOR SHALL BE RESPONSIBLE FOR CORRECTING DEFECTIVE WORK IN EXISTING CONSTRUCTION WITHIN THE LIMITS OF THE CONSTRUCTION AREA. THIS INCLUDES, BUT IS NOT LIMITED TO, UNEVEN SURFACES AND FINISHES AT PLASTER OR GYPSUM BOARD. THE CONTRACTOR SHALL PATCH AND REPAIR SURFACES TO MATCH NEW ADJACENT SURFACES.

### 9. PIPING

ALL PIPING ABOVE GRADE AND INSIDE THE BUILDING REQUIRED BY THE CONSTRUCTION DOCUMENTS SHALL BE INSTALLED IN AREAS WHERE IT WILL BE CONCEALED. THE CONTRACTOR SHALL CONSULT WITH THE ARCHITECT AND COORDINATE WITH OTHER TRADES TO PROVIDE FURRING FOR PIPING INSTALLED IN FINISH AREAS.

### 10. FIXTURE REMOVAL

REMOVE MECHANICAL AND ELECTRICAL FIXTURES AND CAP OR REMOVE EXISTING BRANCH LINES AS INDICATED IN THE MECHANICAL AND ELECTRICAL DOCUMENTS.

### 11. COORDINATION:

COORDINATE PLANS FOR NEW CONSTRUCTION W/ DEMOLITION PLANS FOR EXTENT OF REMOVAL. REMOVE ONLY THOSE PORTIONS OF WALLS, FLOORS, CEILINGS, ETC. NECESSARY TO ACCOMMODATE NEW CONSTRUCTION.

## DEFINITIONS & TERMINOLOGY

### 1. "TYPICAL":

UNLESS NOTED OTHERWISE, MEANS IDENTICAL FOR ALL CONDITIONS, WHICH MATCH ORIGINAL CONDITION INDICATED.

### 2. "SIMILAR":

MEANS COMPARABLE CHARACTERISTICS FOR THE CONDITIONS NOTED. VERIFY DIMENSIONS AND ORIENTATION OF CONDITIONS, WHICH VARY FROM TYPICAL OR SIMILAR CONDITION INDICATED.

### 3. "OPPOSITE HAND":

MEANS CONDITION IS MIRROR IMAGE OF DETAILED REFERENCED.

### 4. "ALIGN":

MEANS ALIGNMENT OF SIMILAR COMPONENTS OF CONSTRUCTION (WALLS,JAMBS,ETC), WHICH ARE ADJACENT OR THE COMPONENTS SHALL BE IN LINE WITH EACH OTHER ACROSS VOIDS. DIMENSIONS ARE NOT ADJUSTABLE UNLESS NOTED WITH PLUS/MINUS TOLERANCE.

### 5. "O.F.O.I.":

MEANS "OWNER FURNISHED, OWNER INSTALLED"

### 6. "U.N.O.":

MEANS "UNLESS NOTED OTHERWISE"

### 7. "O.F.C.I.":

MEANS "OWNER FURNISHED, CONTRACTOR INSTALLED"

### 8. REFERENCES:

ALL REFERENCES TO CONTRACTOR SHALL REFER TO GENERAL CONTRACTOR AND/OR SUB CONTRACTOR. ALL REFERENCES TO THE OWNER SHALL MEAN THE OWNER OR THE OWNER'S AGENT.

BAUER ASKEW  
architecture.pllc

6 1 5  
T 7 2 6 0 0 4 7  
F 7 2 6 4 8 9 1  
6 1 5

1 6 1 5  
s i x t e e n t h  
a v e n u e s o u t h

n a s h v i l l e  
t e n n e s s e e  
3 7 2 1 2



10009.32

TENNESSEE STATE UNIVERSITY  
CENTRAL DAYCARE CENTER

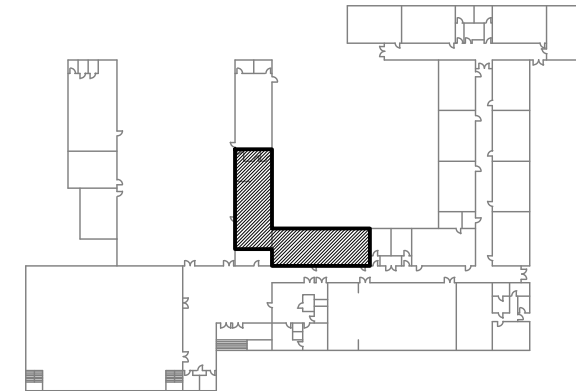

PARIS . TENNESSEE

GENERAL NOTES

Sheet Number

GN.01  
1 6 A P R I L 1 2  
CONSTRUCTION DOCUMENTS







10009.32

TENNESSEE STATE UNIVERSITY  
HUMBOLDT DAYCARE CENTER

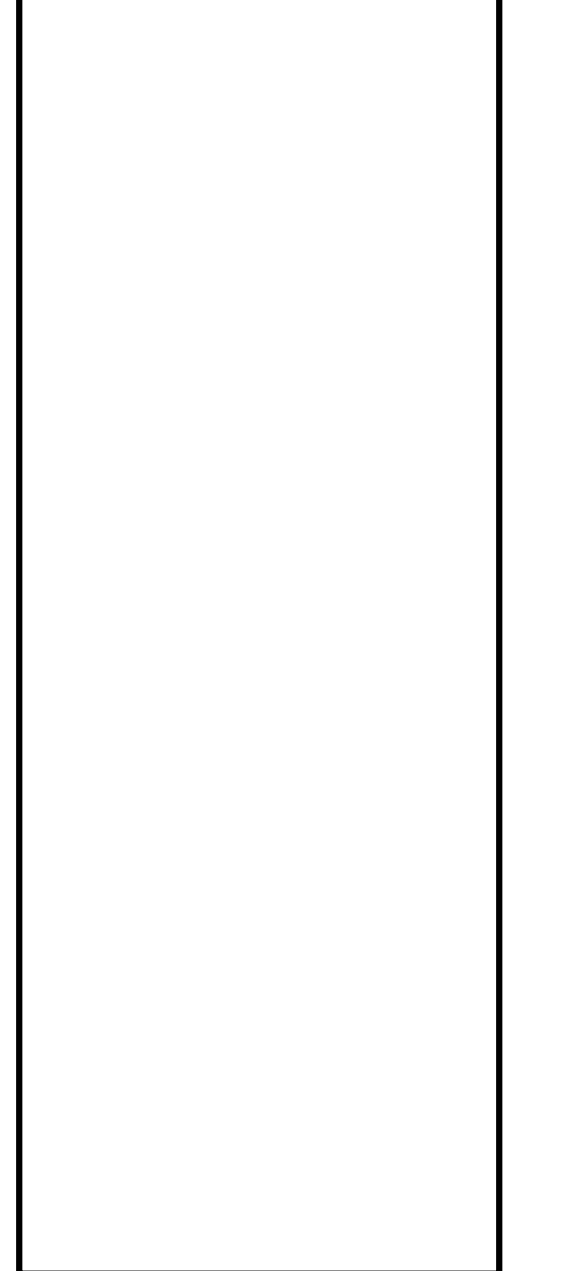

HUMBOLDT.TENNESSEE

SITE PLAN

Sheet Number

L1.01

16 APRIL 12  
CONSTRUCTION DOCUMENTS

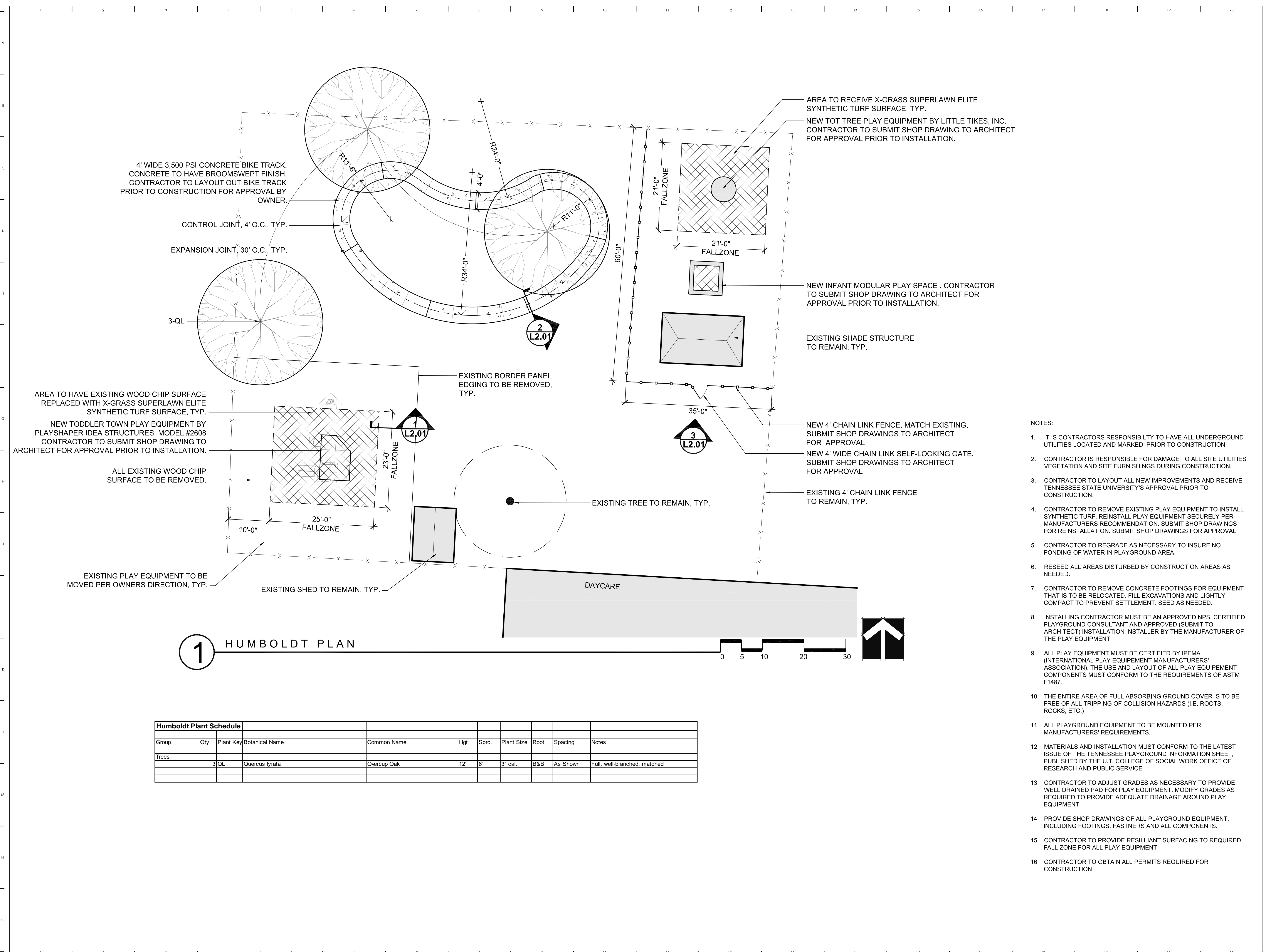

- NOTES:
- IT IS CONTRACTORS RESPONSIBILITY TO HAVE ALL UNDERGROUND UTILITIES LOCATED AND MARKED PRIOR TO CONSTRUCTION.
  - CONTRACTOR IS RESPONSIBLE FOR DAMAGE TO ALL SITE UTILITIES VEGETATION AND SITE FURNISHINGS DURING CONSTRUCTION.
  - CONTRACTOR TO LAYOUT ALL NEW IMPROVEMENTS AND RECEIVE TENNESSEE STATE UNIVERSITY'S APPROVAL PRIOR TO CONSTRUCTION.
  - CONTRACTOR TO REMOVE EXISTING PLAY EQUIPMENT TO INSTALL SYNTHETIC TURF. REINSTALL PLAY EQUIPMENT SECURELY PER MANUFACTURERS RECOMMENDATION. SUBMIT SHOP DRAWINGS FOR REINSTALLATION. SUBMIT SHOP DRAWINGS FOR APPROVAL.
  - CONTRACTOR TO REGRADE AS NECESSARY TO INSURE NO PONDING OF WATER IN PLAYGROUND AREA.
  - RESEED ALL AREAS DISTURBED BY CONSTRUCTION AREAS AS NEEDED.
  - CONTRACTOR TO REMOVE CONCRETE FOOTINGS FOR EQUIPMENT THAT IS TO BE RELOCATED. FILL EXCAVATIONS AND LIGHTLY COMPACT TO PREVENT SETTLEMENT. SEED AS NEEDED.
  - INSTALLING CONTRACTOR MUST BE AN APPROVED NPSI CERTIFIED PLAYGROUND CONSULTANT AND APPROVED (SUBMIT TO ARCHITECT) INSTALLATION INSTALLER BY THE MANUFACTURER OF THE PLAY EQUIPMENT.
  - ALL PLAY EQUIPMENT MUST BE CERTIFIED BY IPEMA (INTERNATIONAL PLAY EQUIPMENT MANUFACTURERS' ASSOCIATION). THE USE AND LAYOUT OF ALL PLAY EQUIPMENT COMPONENTS MUST CONFORM TO THE REQUIREMENTS OF ASTM F1487.
  - THE ENTIRE AREA OF FULL ABSORBING GROUND COVER IS TO BE FREE OF ALL TRIPPING OF COLLISION HAZARDS (I.E. ROOTS, ROCKS, ETC.)
  - ALL PLAYGROUND EQUIPMENT TO BE MOUNTED PER MANUFACTURERS' REQUIREMENTS.
  - MATERIALS AND INSTALLATION MUST CONFORM TO THE LATEST ISSUE OF THE TENNESSEE PLAYGROUND INFORMATION SHEET, PUBLISHED BY THE U.T. COLLEGE OF SOCIAL WORK OFFICE OF RESEARCH AND PUBLIC SERVICE.
  - CONTRACTOR TO ADJUST GRADES AS NECESSARY TO PROVIDE WELL DRAINED PAD FOR PLAY EQUIPMENT. MODIFY GRADES AS REQUIRED TO PROVIDE ADEQUATE DRAINAGE AROUND PLAY EQUIPMENT.
  - PROVIDE SHOP DRAWINGS OF ALL PLAYGROUND EQUIPMENT, INCLUDING FOOTINGS, FASTNERS AND ALL COMPONENTS.
  - CONTRACTOR TO PROVIDE RESILLIANT SURFACING TO REQUIRED FALL ZONE FOR ALL PLAY EQUIPMENT.
  - CONTRACTOR TO OBTAIN ALL PERMITS REQUIRED FOR CONSTRUCTION.

Humboldt Plant Schedule										
Group	Qty	Plant Key	Botanical Name	Common Name	Hgt	Spr.	Plant Size	Root	Spacing	Notes
Trees		3 QL	Quercus lyrata	Overcup Oak	12'	6'	3" cal.	B&B	As Shown	Full, well-branched, matched



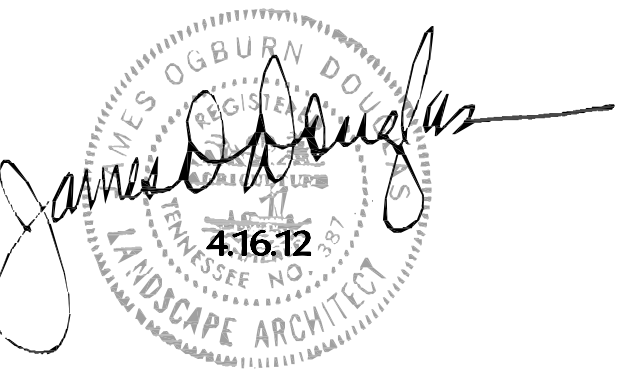

10009.32

TENNESSEE STATE UNIVERSITY  
PARIS DAYCARE CENTER

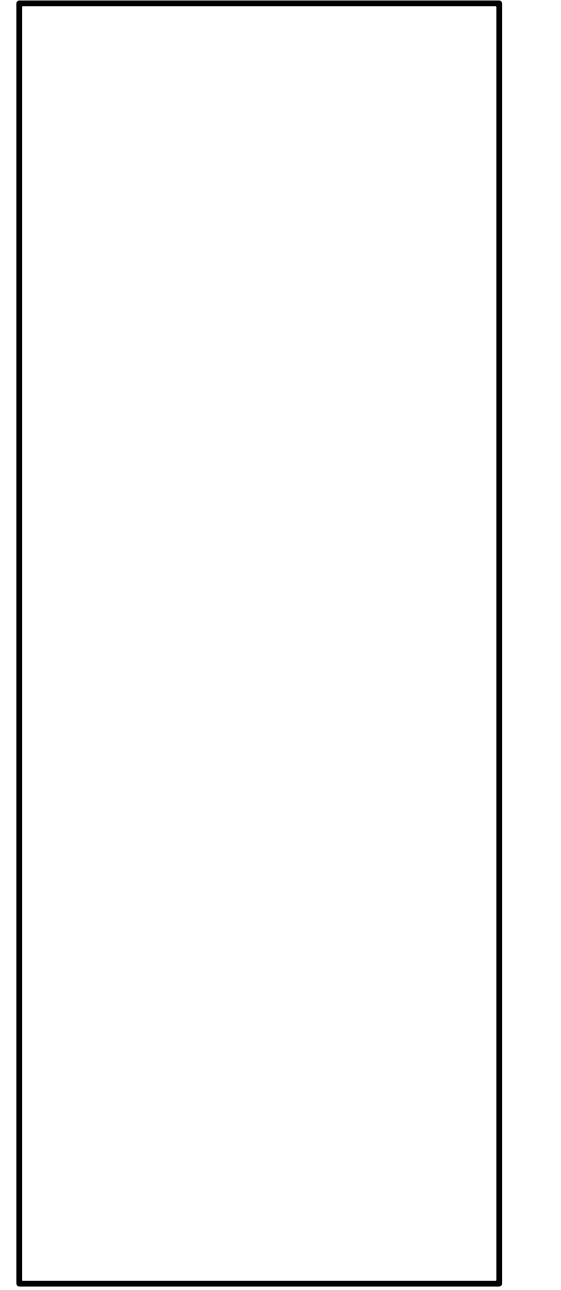

PARIS . TENNESSEE

SITE PLAN

Sheet Number

L1.02

16 APRIL 12  
CONSTRUCTION DOCUMENTS

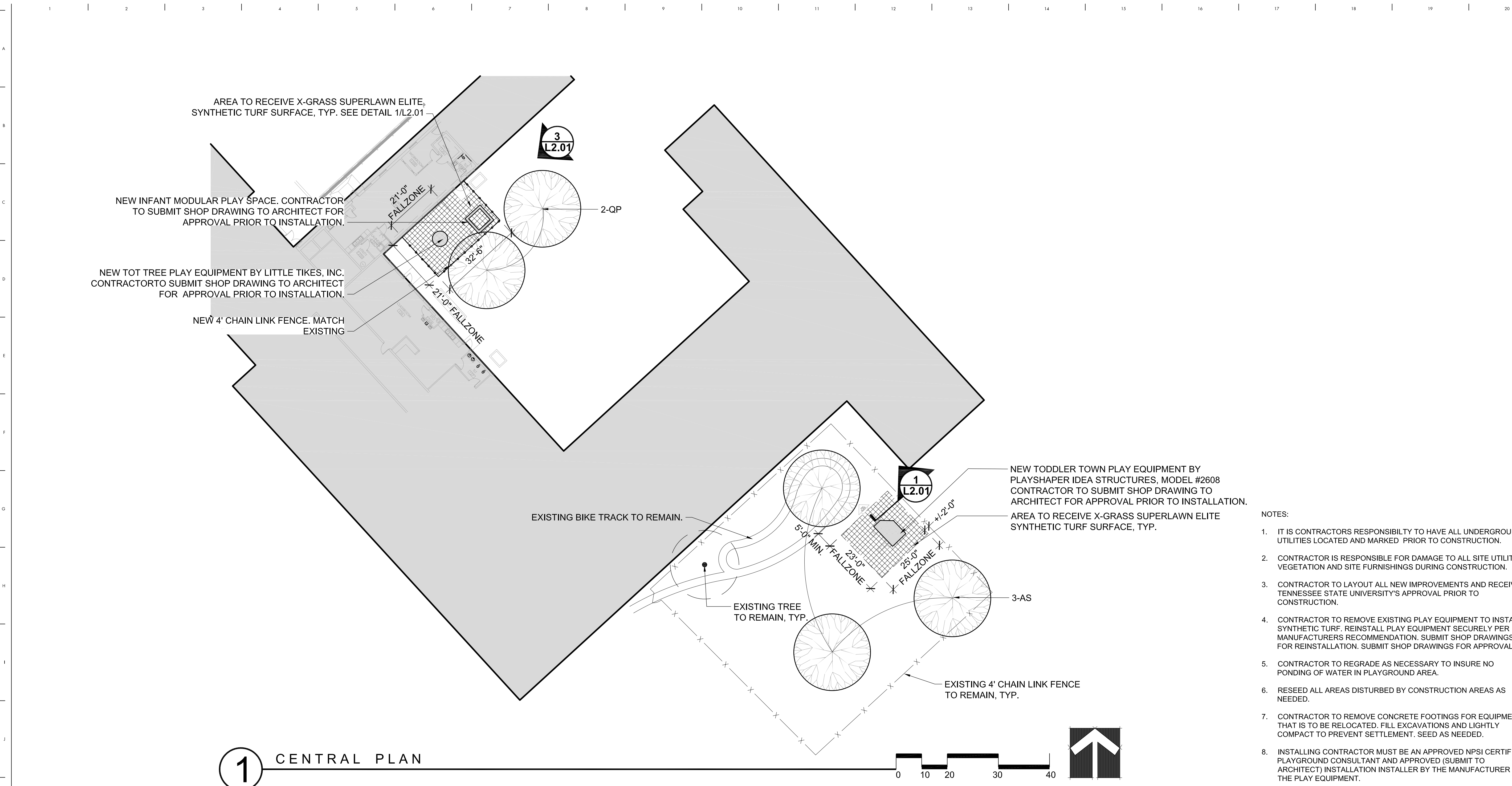

**1 CENTRAL PLAN**

Central Plant Schedule										
Group	Qty	Plant Key	Botanical Name	Common Name	Hgt	Sprd	Plant Size	Root	Spacing	Notes
Trees										
	3	AS	Acer saccharum 'Green Mountain'	Sugar Maple 'Green Mountain'	12'	4'	3" cal.	B&B	As Shown	Dense, well-branched, full crown
	2	QP	Quercus phellos	Willow Oak	12'	6'	3" cal.	B&B	As Shown	Dense, well-branched, full crown

**NOTES:**

- IT IS CONTRACTORS RESPONSIBILITY TO HAVE ALL UNDERGROUND UTILITIES LOCATED AND MARKED PRIOR TO CONSTRUCTION.
- CONTRACTOR IS RESPONSIBLE FOR DAMAGE TO ALL SITE UTILITIES VEGETATION AND SITE FURNISHINGS DURING CONSTRUCTION.
- CONTRACTOR TO LAYOUT ALL NEW IMPROVEMENTS AND RECEIVE TENNESSEE STATE UNIVERSITY'S APPROVAL PRIOR TO CONSTRUCTION.
- CONTRACTOR TO REMOVE EXISTING PLAY EQUIPMENT TO INSTALL SYNTHETIC TURF. REINSTALL PLAY EQUIPMENT SECURELY PER MANUFACTURERS RECOMMENDATION. SUBMIT SHOP DRAWINGS FOR REINSTALLATION. SUBMIT SHOP DRAWINGS FOR APPROVAL.
- CONTRACTOR TO REGRADE AS NECESSARY TO INSURE NO PONDING OF WATER IN PLAYGROUND AREA.
- RESEED ALL AREAS DISTURBED BY CONSTRUCTION AREAS AS NEEDED.
- CONTRACTOR TO REMOVE CONCRETE FOOTINGS FOR EQUIPMENT THAT IS TO BE RELOCATED. FILL EXCAVATIONS AND LIGHTLY COMPACT TO PREVENT SETTLEMENT. SEED AS NEEDED.
- INSTALLING CONTRACTOR MUST BE AN APPROVED NPSI CERTIFIED PLAYGROUND CONSULTANT AND APPROVED (SUBMIT TO ARCHITECT) INSTALLATION INSTALLER BY THE MANUFACTURER OF THE PLAY EQUIPMENT.
- ALL PLAY EQUIPMENT MUST BE CERTIFIED BY IPEMA (INTERNATIONAL PLAY EQUIPMENT MANUFACTURERS' ASSOCIATION). THE USE AND LAYOUT OF ALL PLAY EQUIPMENT COMPONENTS MUST CONFORM TO THE REQUIREMENTS OF ASTM F1487.
- THE ENTIRE AREA OF FULL ABSORBING GROUND COVER IS TO BE FREE OF ALL TRIPPING OF COLLISION HAZARDS (I.E. ROOTS, ROCKS, ETC.)
- ALL PLAYGROUND EQUIPMENT TO BE MOUNTED PER MANUFACTURERS' REQUIREMENTS.
- MATERIALS AND INSTALLATION MUST CONFORM TO THE LATEST ISSUE OF THE TENNESSEE PLAYGROUND INFORMATION SHEET, PUBLISHED BY THE U.T. COLLEGE OF SOCIAL WORK OFFICE OF RESEARCH AND PUBLIC SERVICE.
- CONTRACTOR TO ADJUST GRADES AS NECESSARY TO PROVIDE WELL DRAINED PAD FOR PLAY EQUIPMENT. MODIFY GRADES AS REQUIRED TO PROVIDE ADEQUATE DRAINAGE AROUND PLAY EQUIPMENT.
- PROVIDE SHOP DRAWINGS OF ALL PLAYGROUND EQUIPMENT, INCLUDING FOOTINGS, FASTNERS AND ALL COMPONENTS.
- CONTRACTOR TO PROVIDE RESILLIANT SURFACING TO REQUIRED FALL ZONE FOR ALL PLAY EQUIPMENT.
- CONTRACTOR TO OBTAIN ALL PERMITS REQUIRED FOR CONSTRUCTION.



10009.32

TENNESSEE STATE UNIVERSITY  
DRESDEN DAYCARE CENTER

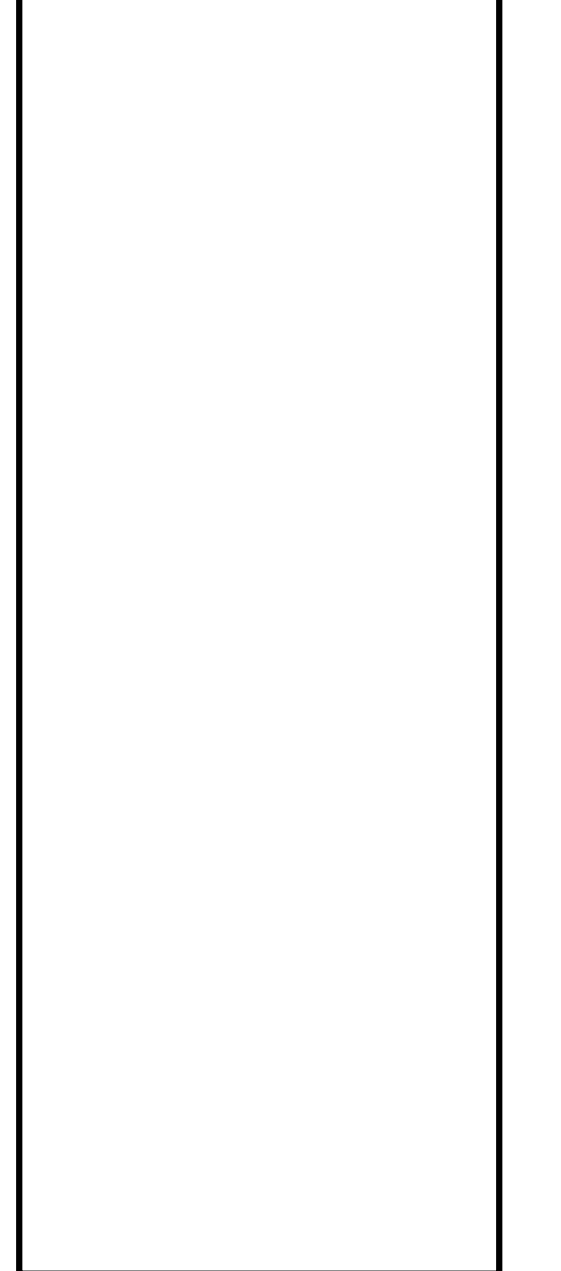

DRESDEN, TENNESSEE

SITE PLAN

Sheet Number

L1.03

16 APRIL 12  
CONSTRUCTION DOCUMENTS

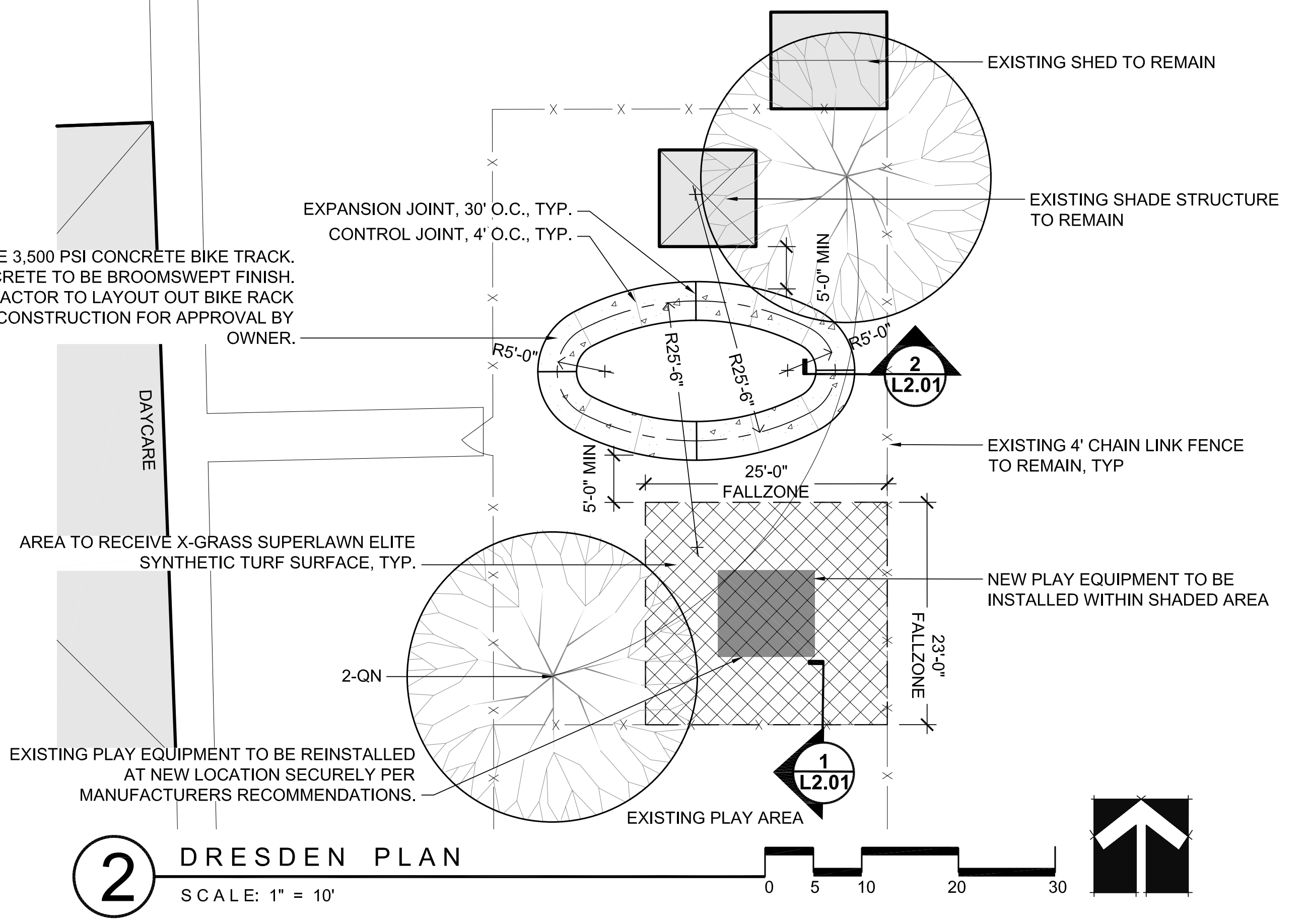
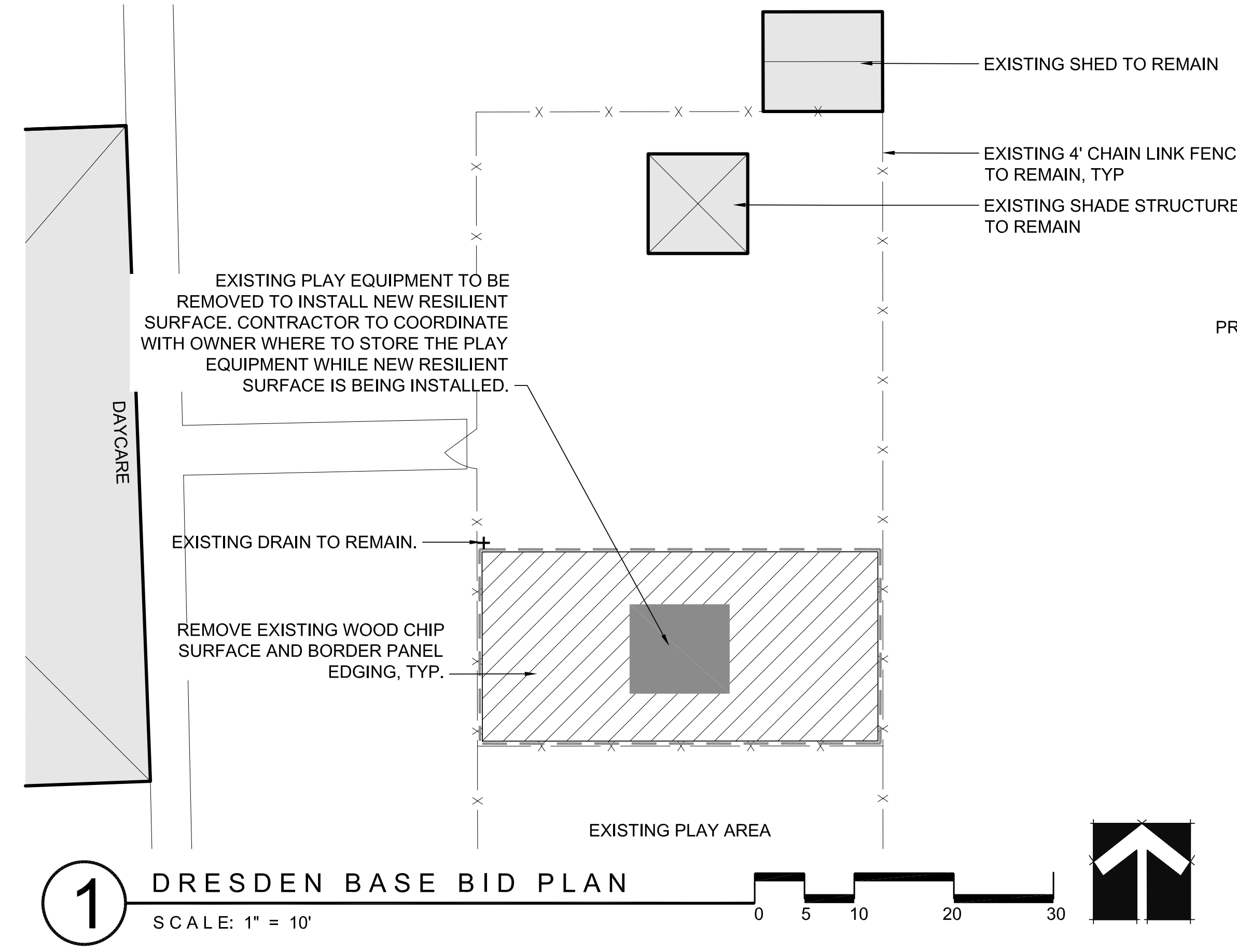

**NOTES:**

1. IT IS CONTRACTORS RESPONSIBILITY TO HAVE ALL UNDERGROUND UTILITIES LOCATED AND MARKED PRIOR TO CONSTRUCTION.
2. CONTRACTOR IS RESPONSIBLE FOR DAMAGE TO ALL SITE UTILITIES VEGETATION AND SITE FURNISHINGS DURING CONSTRUCTION.
3. CONTRACTOR TO LAYOUT ALL NEW IMPROVEMENTS AND RECEIVE TENNESSEE STATE UNIVERSITY'S APPROVAL PRIOR TO CONSTRUCTION.
4. CONTRACTOR TO REMOVE EXISTING PLAY EQUIPMENT TO INSTALL SYNTHETIC TURF. REINSTALL PLAY EQUIPMENT SECURELY PER MANUFACTURERS RECOMMENDATION. SUBMIT SHOP DRAWINGS FOR REINSTALLATION. SUBMIT SHOP DRAWINGS FOR APPROVAL
5. CONTRACTOR TO REGRADE AS NECESSARY TO INSURE NO PONDING OF WATER IN PLAYGROUND AREA.
6. RESEED ALL AREAS DISTURBED BY CONSTRUCTION AREAS AS NEEDED.
7. CONTRACTOR TO REMOVE CONCRETE FOOTINGS FOR EQUIPMENT THAT IS TO BE RELOCATED. FILL EXCAVATIONS AND LIGHTLY COMPACT TO PREVENT SETTLEMENT. SEED AS NEEDED.
8. INSTALLING CONTRACTOR MUST BE AN APPROVED NPSI CERTIFIED PLAYGROUND CONSULTANT AND APPROVED (SUBMIT TO ARCHITECT) INSTALLATION INSTALLER BY THE MANUFACTURER OF THE PLAY EQUIPMENT.
9. ALL PLAY EQUIPMENT MUST BE CERTIFIED BY IPEMA (INTERNATIONAL PLAY EQUIPEMENT MANUFACTURERS' ASSOCIATION). THE USE AND LAYOUT OF ALL PLAY EQUIPMENT COMPONENTS MUST CONFORM TO THE REQUIREMENTS OF ASTM F1487.
10. THE ENTIRE AREA OF FULL ABSORBING GROUND COVER IS TO BE FREE OF ALL TRIPPING OF COLLISION HAZARDS (I.E. ROOTS, ROCKS, ETC.)
11. ALL PLAYGROUND EQUIPMENT TO BE MOUNTED PER MANUFACTURERS' REQUIREMENTS.
12. MATERIALS AND INSTALLATION MUST CONFORM TO THE LATEST ISSUE OF THE TENNESSEE PLAYGROUND INFORMATION SHEET, PUBLISHED BY THE U.T. COLLEGE OF SOCIAL WORK OFFICE OF RESEARCH AND PUBLIC SERVICE.
13. CONTRACTOR TO ADJUST GRADES AS NECESSARY TO PROVIDE WELL DRAINED PAD FOR PLAY EQUIPMENT. MODIFY GRADES AS REQUIRED TO PROVIDE ADEQUATE DRAINAGE AROUND PLAY EQUIPMENT.
14. PROVIDE SHOP DRAWINGS OF ALL PLAYGROUND EQUIPMENT, INCLUDING FOOTINGS, FASTNERS AND ALL COMPONENTS.
15. CONTRACTOR TO PROVIDE RESILIANT SURFACING TO REQUIRED FALL ZONE FOR ALL PLAY EQUIPMENT.
16. CONTRACTOR TO OBTAIN ALL PERMITS REQUIRED FOR CONSTRUCTION.

Dresden Plant Schedule										
Group	Qty	Plant Key	Botanical Name	Common Name	Hgt	Sprd.	Plant Size	Root	Spacing	Notes
Trees										
	2	QN	Quercus nuttallii	Nuttall Oak	10'	5'	3" cal.	B&B	As Shown	Dense, well-branched, full crown



10009.32

TENNESSEE STATE UNIVERSITY  
MARTIN DAYCARE CENTER

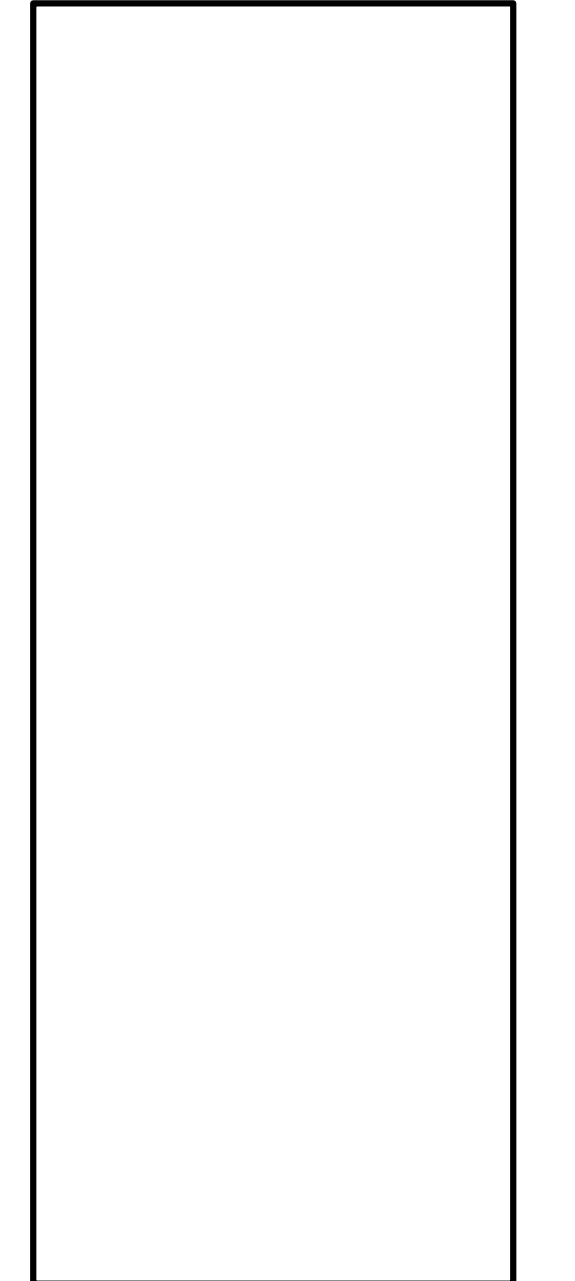

MARTIN, TENNESSEE

SITE PLAN

Sheet Number

L1.04

16 APRIL 12  
CONSTRUCTION DOCUMENTS

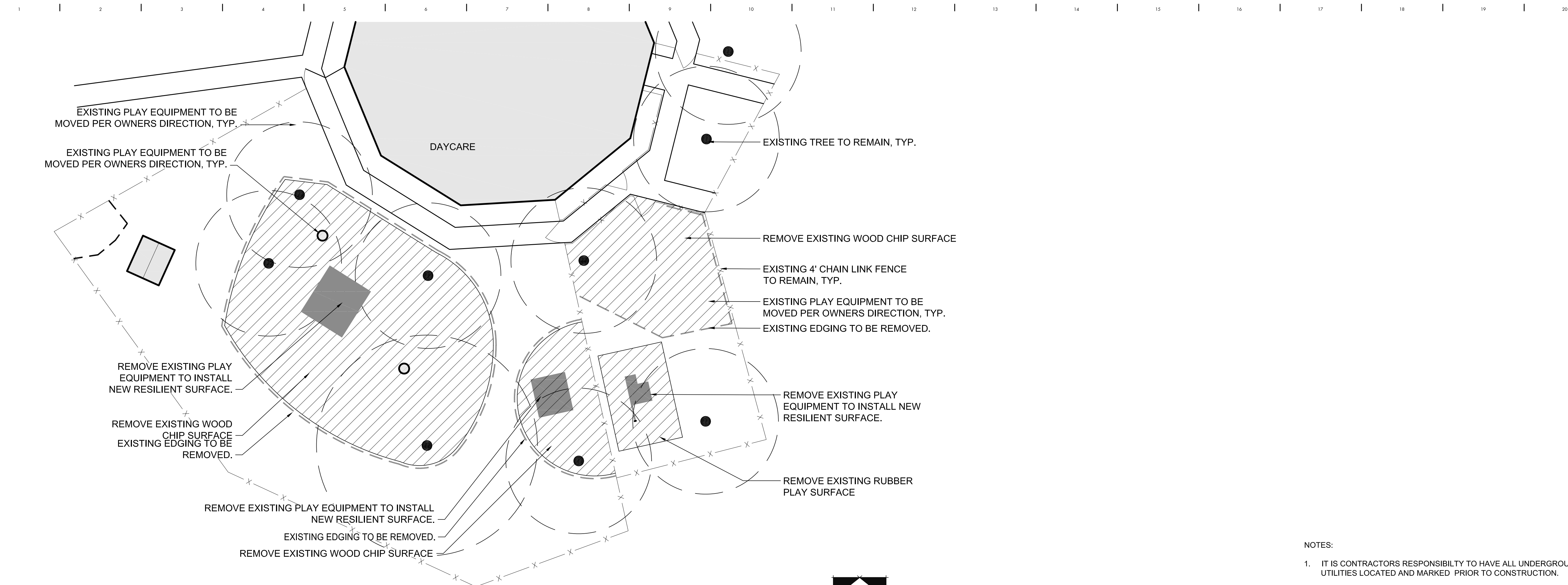

**1** MARTIN DEMOLITION PLAN

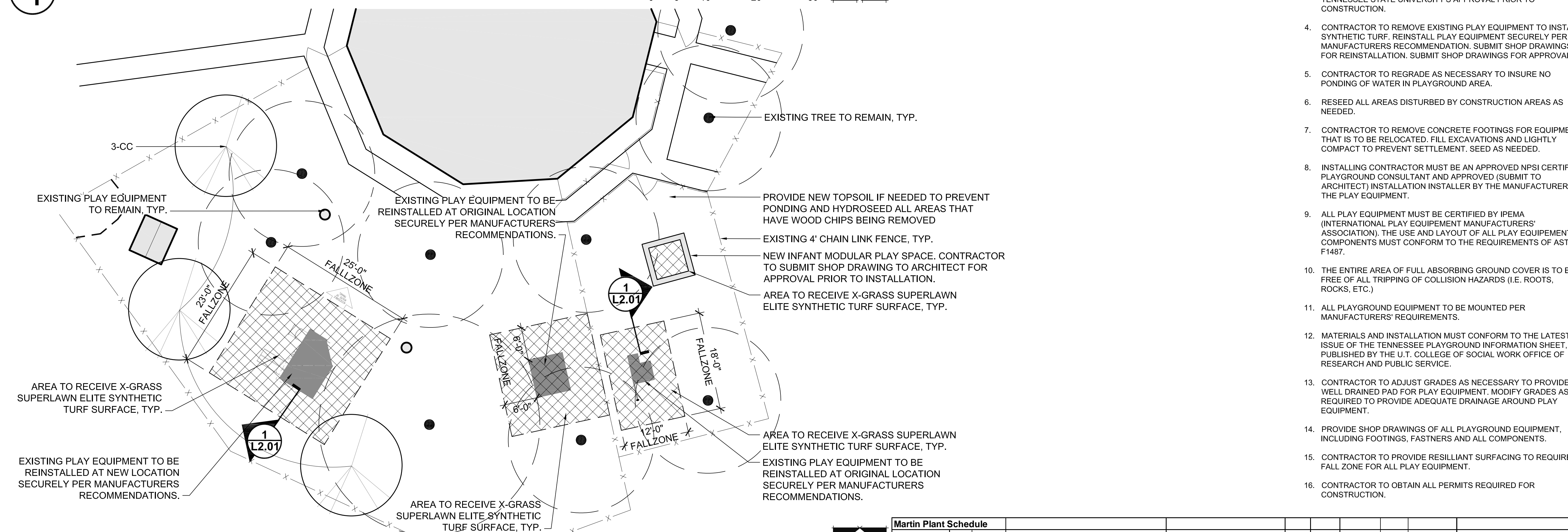

**2** MARTIN PLAN

Martin Plant Schedule										
Group	Qty	Plant Key	Botanical Name	Common Name	Hgt	Sprd.	Plant Size	Root	Spacing	Notes
Trees										
	3	CC	Cercis canadensis	Redbud	8'	4'	2' cal.	B&B	As Shown	Multi-branched, single-trunk spec.



6 5  
T 7 2 6 0 0 4 7  
F 7 2 6 4 8 9 1  
6 5  
1 6 1 5  
s i x t e e n t h  
a v e n u e s o u t h  
n a s h v i l l e  
t e n n e s s e e  
3 7 2 1 2

**Hodgson & Douglas LLC**

landscape architecture · planning · urban design  
120 20th Avenue South Post Office Box 12787  
Nashville, Tennessee 37212  
telephone: 615-327-2427 fax: 615-354-3001



10009.32

TENNESSEE STATE UNIVERSITY  
DAYCARE CENTERS

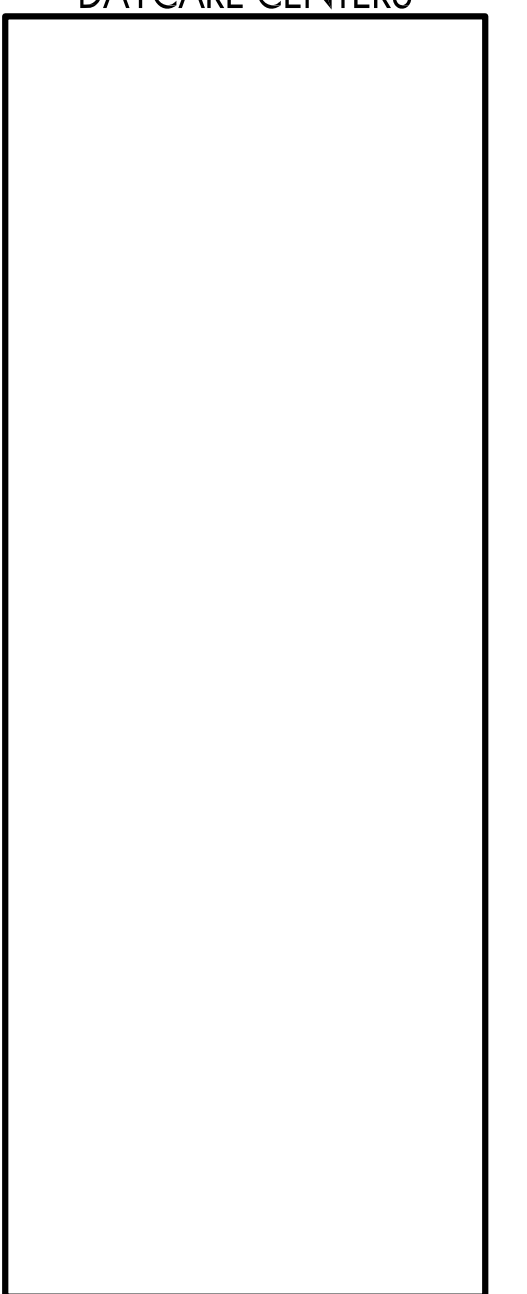

TENNESSEE

PLANTING  
DETAILS  
Sheet Number

L1.05  
16 APRIL 12  
CONSTRUCTION DOCUMENTS

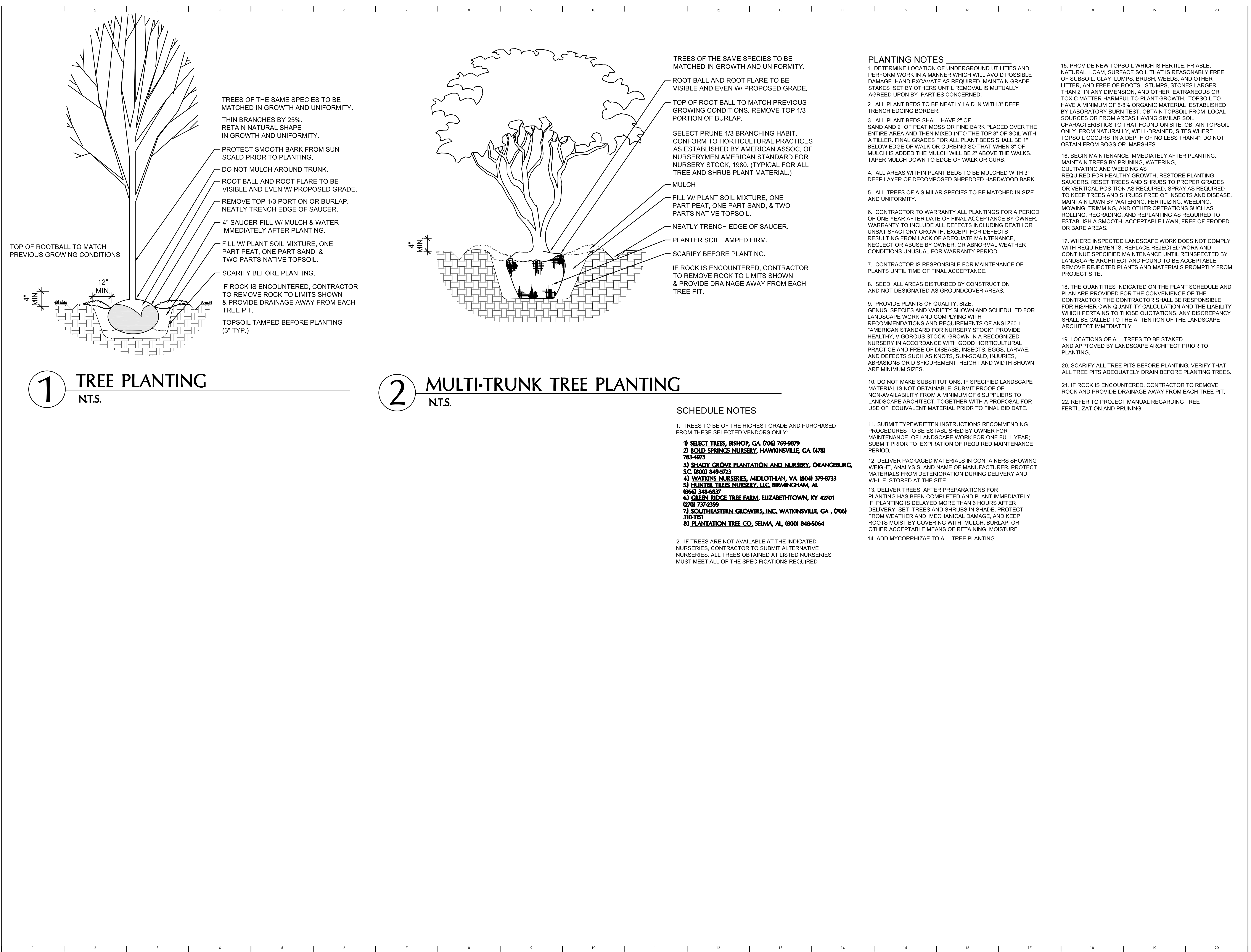

**1 TREE PLANTING**  
N.T.S.

- TREES OF THE SAME SPECIES TO BE MATCHED IN GROWTH AND UNIFORMITY.
- THIN BRANCHES BY 25%. RETAIN NATURAL SHAPE IN GROWTH AND UNIFORMITY.
- PROTECT SMOOTH BARK FROM SUN SCALD PRIOR TO PLANTING.
- DO NOT MULCH AROUND TRUNK.
- ROOT BALL AND ROOT FLARE TO BE VISIBLE AND EVEN W/ PROPOSED GRADE.
- REMOVE TOP 1/3 PORTION OR BURLAP. NEATLY TRENCH EDGE OF SAUCER.
- 4" SAUCER-FILL W/ MULCH & WATER IMMEDIATELY AFTER PLANTING.
- FILL W/ PLANT SOIL MIXTURE, ONE PART PEAT, ONE PART SAND, & TWO PARTS NATIVE TOPSOIL.
- SCARIFY BEFORE PLANTING.
- IF ROCK IS ENCOUNTERED, CONTRACTOR TO REMOVE ROCK TO LIMITS SHOWN & PROVIDE DRAINAGE AWAY FROM EACH TREE PIT.
- TOPSOIL TAMPED BEFORE PLANTING (3" TYP.)

**2 MULTI-TRUNK TREE PLANTING**  
N.T.S.

- TREES OF THE SAME SPECIES TO BE MATCHED IN GROWTH AND UNIFORMITY.
- ROOT BALL AND ROOT FLARE TO BE VISIBLE AND EVEN W/ PROPOSED GRADE.
- TOP OF ROOT BALL TO MATCH PREVIOUS GROWING CONDITIONS. REMOVE TOP 1/3 PORTION OF BURLAP.
- SELECT PRUNE 1/3 BRANCHING HABIT. CONFORM TO HORTICULTURAL PRACTICES AS ESTABLISHED BY AMERICAN ASSOC. OF NURSERYMEN AMERICAN STANDARD FOR NURSERY STOCK, 1980. (TYPICAL FOR ALL TREE AND SHRUB PLANT MATERIAL.)
- MULCH
- FILL W/ PLANT SOIL MIXTURE, ONE PART PEAT, ONE PART SAND, & TWO PARTS NATIVE TOPSOIL.
- NEATLY TRENCH EDGE OF SAUCER.
- PLANTER SOIL TAMPED FIRM.
- SCARIFY BEFORE PLANTING.
- IF ROCK IS ENCOUNTERED, CONTRACTOR TO REMOVE ROCK TO LIMITS SHOWN & PROVIDE DRAINAGE AWAY FROM EACH TREE PIT.

**SCHEDULE NOTES**

1. TREES TO BE OF THE HIGHEST GRADE AND PURCHASED FROM THESE SELECTED VENDORS ONLY:
  - 1) SELECT TREES, BISHOP, CA. (706) 769-9879
  - 2) BOLD SPRINGS NURSERY, HAWKINSVILLE, GA (478) 783-4975
  - 3) SHADY GROVE PLANTATION AND NURSERY, ORANCEBURG, S.C. (800) 849-5723
  - 4) WATKINS NURSERIES, MIDLOTHIAN, VA. (804) 379-8733
  - 5) HUNTER TREES NURSERY, LLC, BIRMINGHAM, AL (866) 348-6837
  - 6) CREEK RIDGE TREE FARM, ELIZABETHTOWN, KY 42701 (270) 737-2399
  - 7) SOUTHEASTERN GROWERS, INC., WATKINSVILLE, GA, (706) 310-1151
  - 8) PLANTATION TREE CO, SELMA, AL, (800) 848-5064
2. IF TREES ARE NOT AVAILABLE AT THE INDICATED NURSERIES, CONTRACTOR TO SUBMIT ALTERNATIVE NURSERIES. ALL TREES OBTAINED AT LISTED NURSERIES MUST MEET ALL OF THE SPECIFICATIONS REQUIRED
3. ALL PLANT BEDS SHALL HAVE 2" OF SAND AND 2" OF PEAT MOSS OR FINE BARK PLACED OVER THE ENTIRE AREA AND THEN MIXED INTO THE TOP 6" OF SOIL WITH A TILLER. FINAL GRADES FOR ALL PLANT BEDS SHALL BE 1" BELOW EDGE OF WALK OR CURBING SO THAT WHEN 3" OF MULCH IS ADDED THE MULCH WILL BE 2" ABOVE THE WALKS. TAPER MULCH DOWN TO EDGE OF WALK OR CURB.
4. ALL AREAS WITHIN PLANT BEDS TO BE MULCHED WITH 3" DEEP LAYER OF DECOMPOSED SHREDDED HARDWOOD BARK.
5. ALL TREES OF A SIMILAR SPECIES TO BE MATCHED IN SIZE AND UNIFORMITY.
6. CONTRACTOR TO WARRANTY ALL PLANTINGS FOR A PERIOD OF ONE YEAR AFTER DATE OF FINAL ACCEPTANCE BY OWNER. WARRANTY TO INCLUDE ALL DEFECTS INCLUDING DEATH OR UNSATISFACTORY GROWTH; EXCEPT FOR DEFECTS RESULTING FROM LACK OF ADEQUATE MAINTENANCE, NEGLECT OR ABUSE BY OWNER, OR ABNORMAL WEATHER CONDITIONS UNUSUAL FOR WARRANTY PERIOD.
7. CONTRACTOR IS RESPONSIBLE FOR MAINTENANCE OF PLANTS UNTIL TIME OF FINAL ACCEPTANCE.
8. SEED ALL AREAS DISTURBED BY CONSTRUCTION AND NOT DESIGNATED AS GROUNDCOVER AREAS.
9. PROVIDE PLANTS OF QUALITY, SIZE, GENUS, SPECIES AND VARIETY SHOWN AND SCHEDULED FOR LANDSCAPE WORK AND COMPLYING WITH RECOMMENDATIONS AND REQUIREMENTS OF ANSI Z60.1 "AMERICAN STANDARD FOR NURSERY STOCK". PROVIDE HEALTHY, VIGOROUS STOCK, GROWN IN A RECOGNIZED NURSERY IN ACCORDANCE WITH GOOD HORTICULTURAL PRACTICE AND FREE OF DISEASE, INSECTS, EGGS, LARVAE, AND DEFECTS SUCH AS KNOTS, SUN-SCALD, INJURIES, ABRASIONS OR DISFIGUREMENT. HEIGHT AND WIDTH SHOWN ARE MINIMUM SIZES.
10. DO NOT MAKE SUBSTITUTIONS. IF SPECIFIED LANDSCAPE MATERIAL IS NOT OBTAINABLE, SUBMIT PROOF OF NON-AVAILABILITY FROM A MINIMUM OF 6 SUPPLIERS TO LANDSCAPE ARCHITECT, TOGETHER WITH A PROPOSAL FOR USE OF EQUIVALENT MATERIAL PRIOR TO FINAL BID DATE.
11. SUBMIT TYPEWRITTEN INSTRUCTIONS RECOMMENDING PROCEDURES TO BE ESTABLISHED BY OWNER FOR MAINTENANCE OF LANDSCAPE WORK FOR ONE FULL YEAR; SUBMIT PRIOR TO EXPIRATION OF REQUIRED MAINTENANCE PERIOD.
12. DELIVER PACKAGED MATERIALS IN CONTAINERS SHOWING WEIGHT, ANALYSIS, AND NAME OF MANUFACTURER. PROTECT MATERIALS FROM DETERIORATION DURING DELIVERY AND WHILE STORED AT THE SITE.
13. DELIVER TREES AFTER PREPARATIONS FOR PLANTING HAS BEEN COMPLETED AND PLANT IMMEDIATELY. IF PLANTING IS DELAYED MORE THAN 6 HOURS AFTER DELIVERY, SET TREES AND SHRUBS IN SHADE, PROTECT FROM WEATHER AND MECHANICAL DAMAGE, AND KEEP ROOTS MOIST BY COVERING WITH MULCH, BURLAP, OR OTHER ACCEPTABLE MEANS OF RETAINING MOISTURE.
14. ADD MYCORRHIZAE TO ALL TREE PLANTING.
15. PROVIDE NEW TOPSOIL WHICH IS FERTILE, FRIABLE, NATURAL LOAM, SURFACE SOIL THAT IS REASONABLY FREE OF SUBSOIL, CLAY LUMPS, BRUSH, WEEDS, AND OTHER LITTER, AND FREE OF ROOTS, STUMPS, STONES LARGER THAN 2" IN ANY DIMENSION, AND OTHER EXTRANEOUS OR TOXIC MATTER HARMFUL TO PLANT GROWTH. TOPSOIL TO HAVE A MINIMUM OF 5-8% ORGANIC MATERIAL. ESTABLISHED BY LABORATORY BURN TEST. OBTAIN TOPSOIL FROM LOCAL SOURCES OR FROM AREAS HAVING SIMILAR SOIL CHARACTERISTICS TO THAT FOUND ON SITE. OBTAIN TOPSOIL ONLY FROM NATURALLY WELL-DRAINED SITES WHERE TOPSOIL OCCURS IN A DEPTH OF NO LESS THAN 4"; DO NOT OBTAIN FROM BOGS OR MARSHES.
16. BEGIN MAINTENANCE IMMEDIATELY AFTER PLANTING. MAINTAIN TREES BY PRUNING, WATERING, CULTIVATING AND WEEDING AS REQUIRED FOR HEALTHY GROWTH. RESTORE PLANTING SAUCERS. RESET TREES AND SHRUBS TO PROPER GRADES OR VERTICAL POSITION AS REQUIRED. SPRAY AS REQUIRED TO KEEP TREES AND SHRUBS FREE OF INSECTS AND DISEASE. MAINTAIN LAWN BY WATERING, FERTILIZING, WEEDING, MOWING, TRIMMING, AND OTHER OPERATIONS SUCH AS ROLLING, REGRADING, AND REPLANTING AS REQUIRED TO ESTABLISH A SMOOTH, ACCEPTABLE LAWN, FREE OF ERODED OR BARE AREAS.
17. WHERE INSPECTED LANDSCAPE WORK DOES NOT COMPLY WITH REQUIREMENTS, REPLACE REJECTED WORK AND CONTINUE SPECIFIED MAINTENANCE UNTIL REINSPECTED BY LANDSCAPE ARCHITECT AND FOUND TO BE ACCEPTABLE. REMOVE REJECTED PLANTS AND MATERIALS PROMPTLY FROM PROJECT SITE.
18. THE QUANTITIES INDICATED ON THE PLANT SCHEDULE AND PLAN ARE PROVIDED FOR THE CONVENIENCE OF THE CONTRACTOR. THE CONTRACTOR SHALL BE RESPONSIBLE FOR HIS/HER OWN QUANTITY CALCULATION AND THE LIABILITY WHICH PERTAINS TO THOSE QUOTATIONS. ANY DISCREPANCY SHALL BE CALLED TO THE ATTENTION OF THE LANDSCAPE ARCHITECT IMMEDIATELY.
19. LOCATIONS OF ALL TREES TO BE STAKED AND APPROVED BY LANDSCAPE ARCHITECT PRIOR TO PLANTING.
20. SCARIFY ALL TREE PITS BEFORE PLANTING. VERIFY THAT ALL TREE PITS ADEQUATELY DRAIN BEFORE PLANTING TREES.
21. IF ROCK IS ENCOUNTERED, CONTRACTOR TO REMOVE ROCK AND PROVIDE DRAINAGE AWAY FROM EACH TREE PIT.
22. REFER TO PROJECT MANUAL REGARDING TREE FERTILIZATION AND PRUNING.



10009.32

TENNESSEE STATE UNIVERSITY  
DAYCARE CENTERS

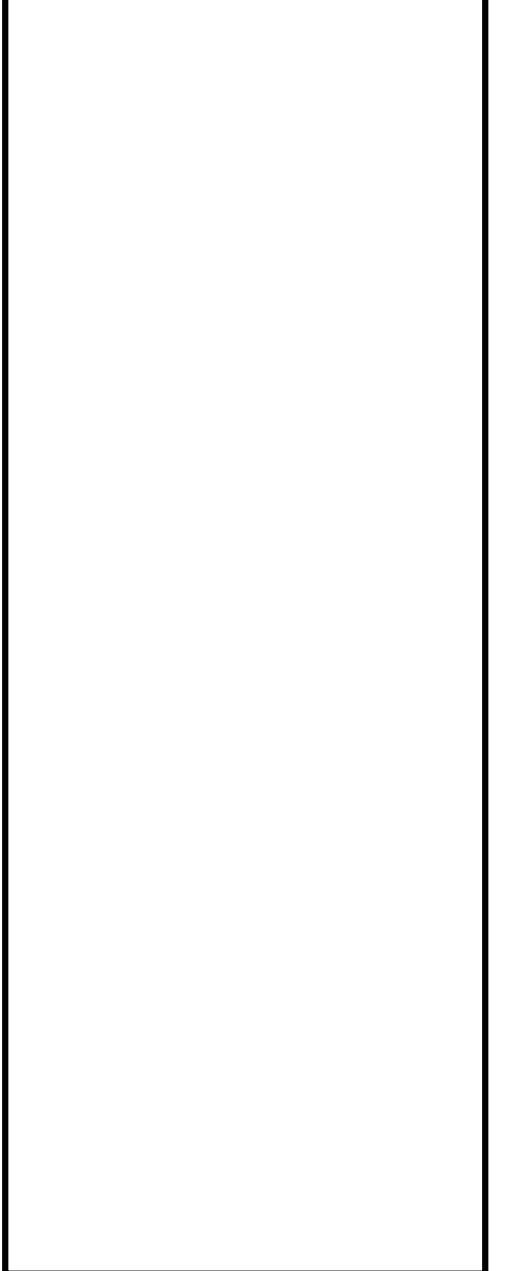

SITE DETAILS

Sheet Number

L2.01  
16 APRIL 12  
CONSTRUCTION DOCUMENTS

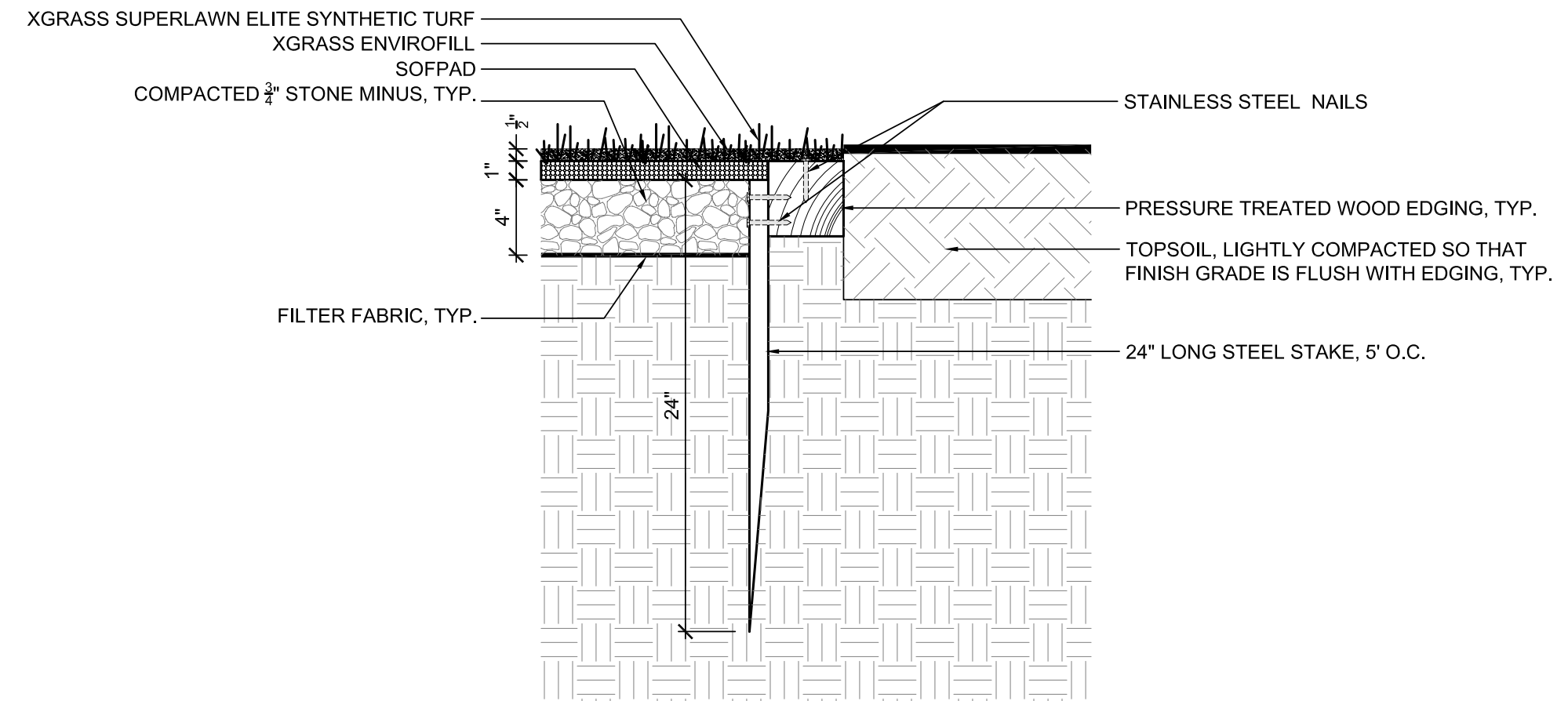

1 SYNTHETIC TURF SECTION

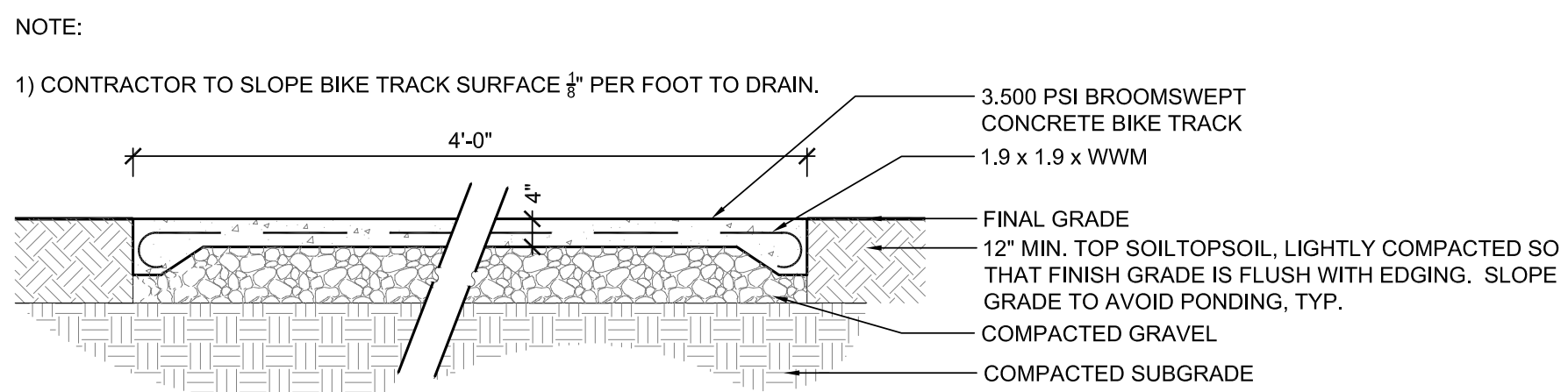

2 BIKE TRACK SECTION

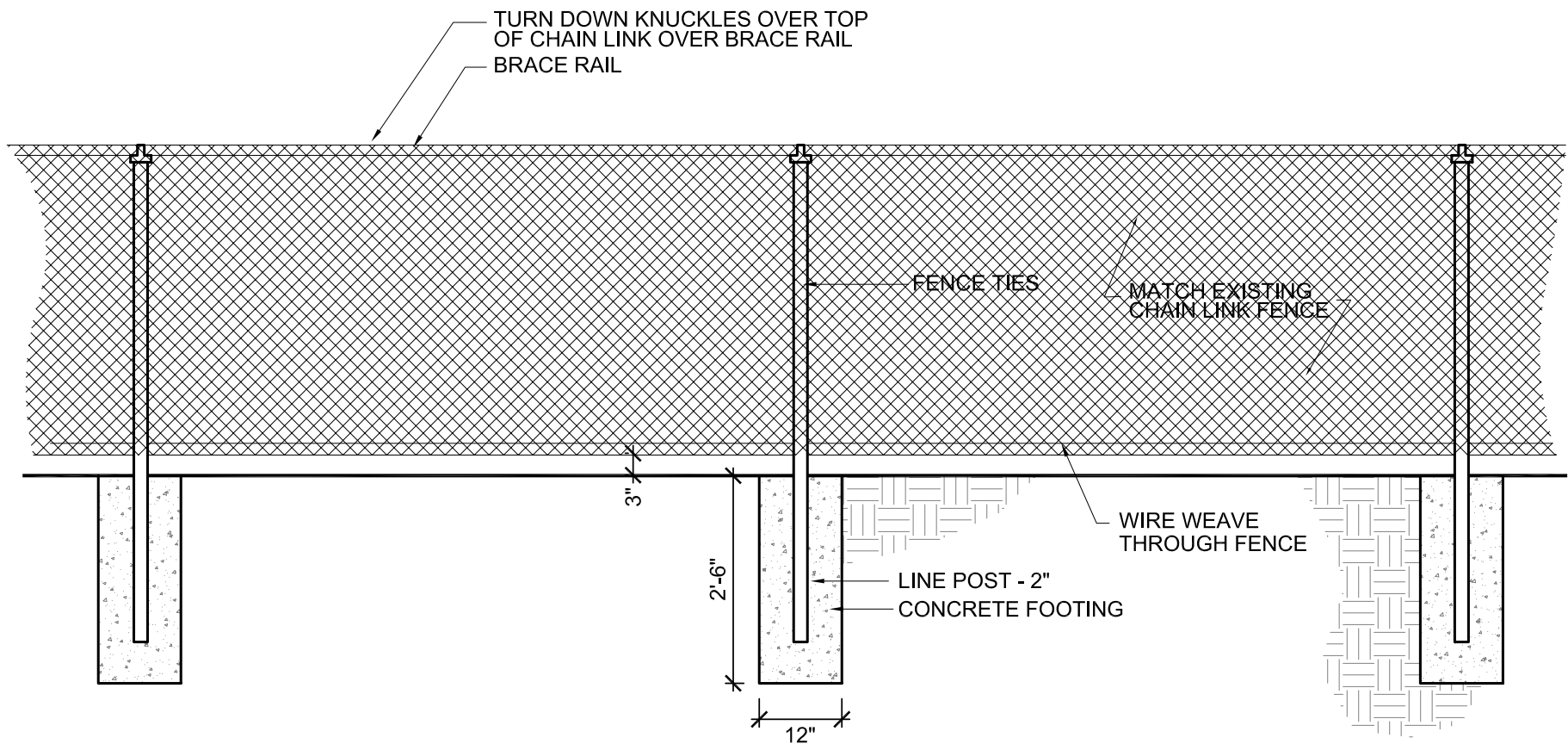

3 FENCE DETAIL

NOTES  
1. CONTRACTOR SHALL INSPECT THE FENCE TO VERIFY NO SHARP PROTRUSIONS EXIST ON TOP OF FENCE - BOTTOM OR ANY WIRE TIES.  
2. CONTRACTOR TO MATCH HEIGHT AND FINISH OF EXISTING FENCE AT EACH SITE WHERE PROPOSED FENCING IS CALLED OUT.

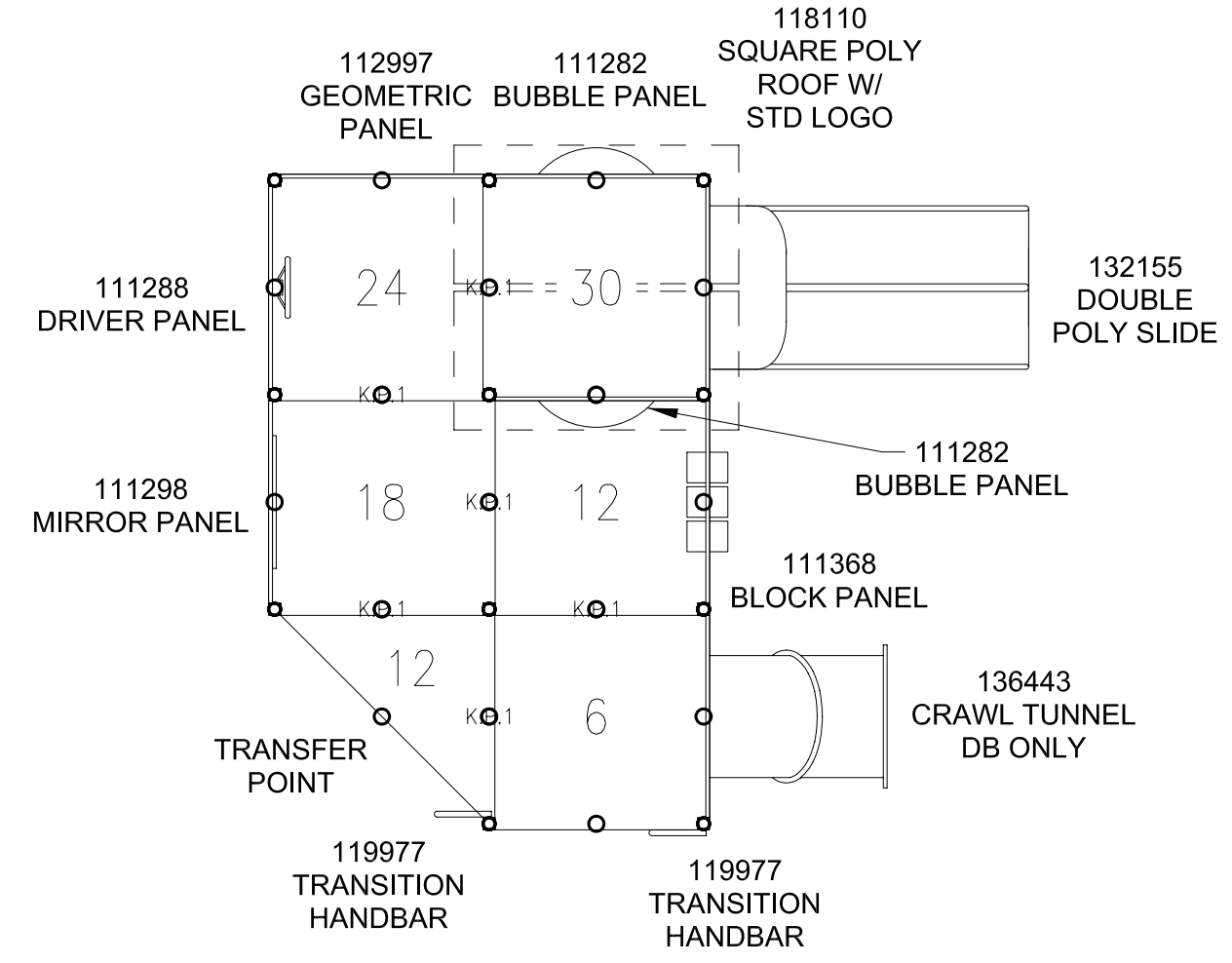

4 TODDLER TOWN n.t.s.

NOTE:  
1) CONTRACTOR TO SUBMIT SHOP DRAWINGS FOR PLAY EQUIPMENT PRIOR TO INSTALLATION.  
2) PLAY EQUIPMENT TO BE INSTALL PER MANUFACTURER'S RECOMMENDATION.  
3) SEE STIE PLANS FOR FALL ZONE DIMENSIONS.