

1. On your Android mobile device (phone or tablet), locate your **Google Play App**.

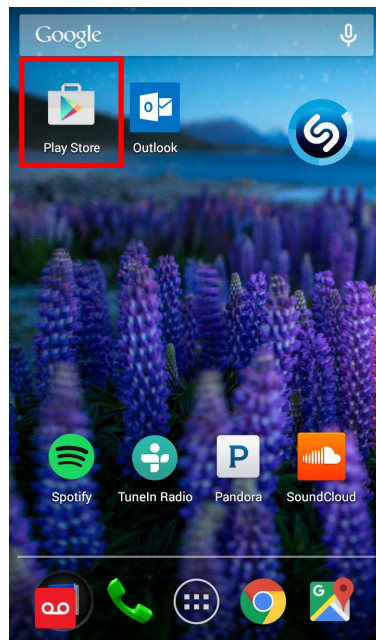

2. In **Google Play**, search for **Outlook**.

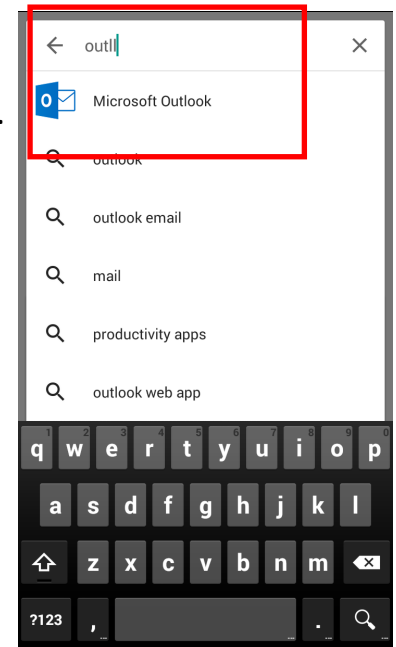

3. Select the **Microsoft Outlook App** and install to your Android mobile device.

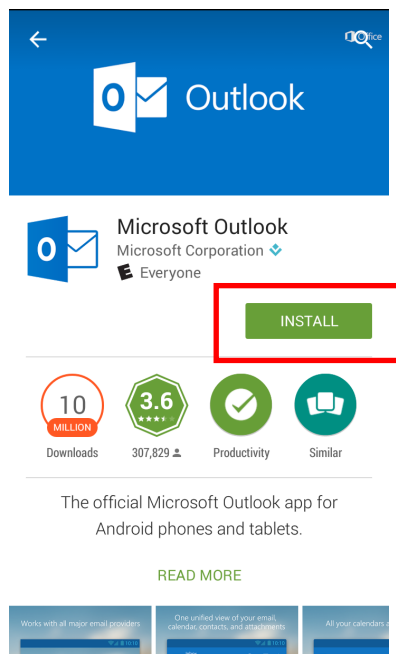

4. When the app has been installed, select **Open in Google Play** or locate it in your apps.

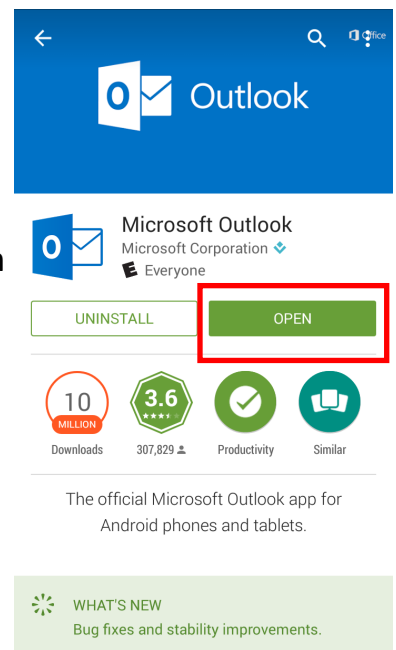

5. Once located, open **Microsoft Outlook**. It will bring you to the following screen. Select **Get Started**.

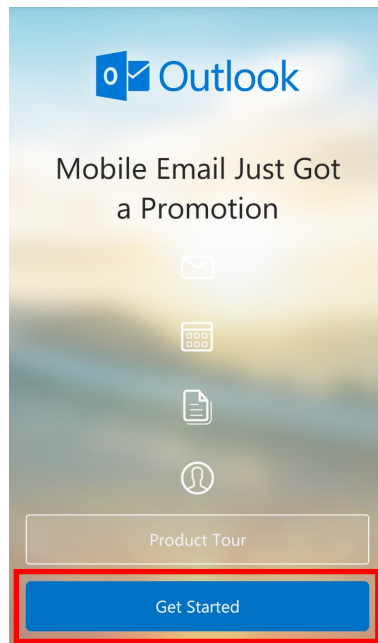

7. You will be brought to the following log in screen.

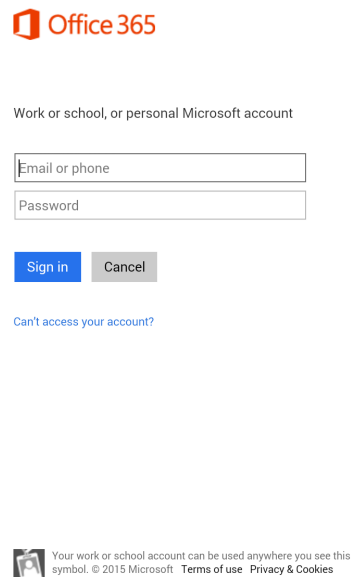

6. For student email, select **Office 365**.

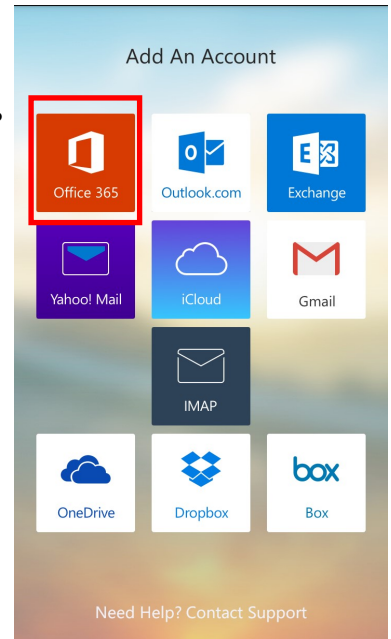

8. Enter your **complete student email address** and your computer and TSU Elearn password.

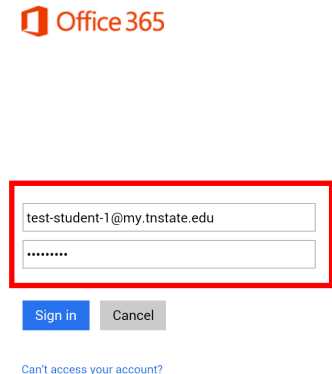

9. If entered correctly, you will be brought to a loading screen.

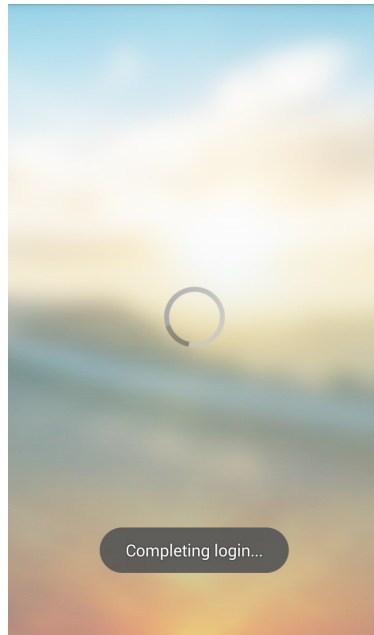

10. You will be told about the features of the application. Select **See More** for information, or **Got It** to go directly to your inbox.

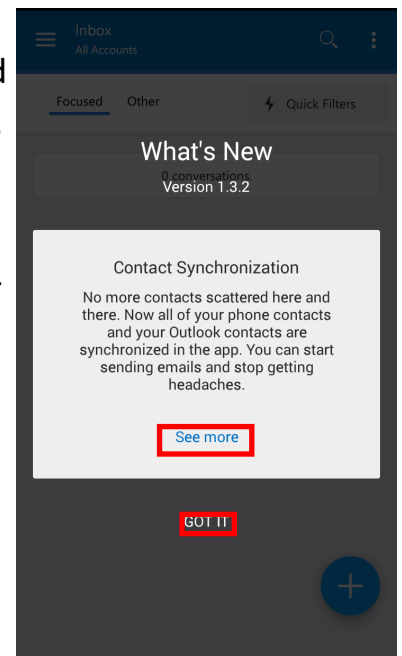

11. Now you have access to your student email through the **Microsoft Outlook App**.

